

**LEGEND**

±	MORE OR LESS
DH	DRILL HOLE
ELEV	ELEVATION
N/F	NOW OR FORMERLY
PROP	PROPOSED
(F)	FOUND
REF	REFERENCE
SNET	SOUTHERN NEW ENGLAND TELEPHONE
SF	SQUARE FEET
TYP	TYPICAL
---	BUILDING SETBACK LINE
- - -	EXIST CONTOUR LINE, 2' INTERVAL
- - -	EXIST CONTOUR LINE, 10' INTERVAL
⊙	IRON PIN OR DRILL HOLE
•	PROPERTY POINT
⋯	STONEWALL
⋯	EXISTING TREELINE
⊘	UTILITY POLE
⊙	WELL
⊕	PERCOLATION TEST LOCATION
⊕	TEST HOLE LOCATION

**REFERENCE NOTES**

- THIS MAP AND SURVEY HAVE BEEN PREPARED IN ACCORDANCE WITH SECTIONS 20-300B-1 THROUGH 20-300B-30 OF THE REGULATIONS OF CONNECTICUT STATE AGENCIES - "MINIMUM STANDARDS OF ACCURACY, CONTENT AND CERTIFICATION FOR SURVEYS AND MAPS", ADOPTED EFFECTIVE JUNE 21, 1996, REVISED OCTOBER 26, 2018. FOR THE PURPOSES OF THIS PLAN, THE PROPERTY BOUNDARIES WERE CONFIRMED IN THE AREA OF LOT DEVELOPMENT ONLY. IT IS AN "IMPROVEMENT LOCATION SURVEY" CONFORMING TO HORIZONTAL ACCURACY "CLASS A-2" STANDARDS. THE BOUNDARY DETERMINATION CATEGORY IS A "RESURVEY". REFERENCE MAY BE MADE TO NORTH AMERICAN DATUM OF 1983 (NAD 83/87). TOPOGRAPHIC INFORMATION DEPICTED HEREON CONFORMS TO TOPOGRAPHIC ACCURACY "CLASS T-2" STANDARDS. REFERENCE MAY BE MADE TO NORTH AMERICAN VERTICAL DATUM OF 1988 (NAVD88). THE PURPOSE OF THIS SURVEY IS TO DEPICT EXISTING CONDITIONS AND A PROPOSED RESIDENTIAL SITE PLAN.
- REFERENCE MAY BE MADE TO THE FOLLOWING DEED RECORDED IN THE TOWN OF MONTVILLE LAND RECORDS:  
VOLUME: 646 PAGES: 488-490  
TYPE: CERTIFICATE OF DEVISE, DESCENT OR DISTRIBUTION  
GRANTOR: ESTATE OF KATHERINE M. BREEDEN A.K.A. KATHERINE M. NASON  
GRANTEE: LYNNE KING  
DATE EXECUTED: 7-03-2019 DATE RECORDED: 7-22-2019
- REFERENCE MAY BE MADE TO THE FOLLOWING PLANS:  
"RIDGE HILL ACRES SUBDIVISION OF LAND OF FRANCIS WILLIAM PERRY, SR. MONTVILLE, CONN. SCALE: 1"=100' DATE: 10-18-1966 SHEET 2 OF 2" PREPARED BY FREDERICK A. RADCLIFFE CONSULTING CIVIL ENGINEER. (FILED MAP 253)
- UNDERGROUND UTILITY, STRUCTURE AND FACILITY LOCATIONS DEPICTED AND NOTED HEREON HAVE BEEN COMPILED, IN PART, FROM RECORD MAPPING, PAROL TESTIMONY AND OTHER SOURCES. THESE LOCATIONS MUST BE CONSIDERED AS APPROXIMATE IN NATURE. ADDITIONALLY, OTHER SUCH FEATURES MAY EXIST ON THE SITE, THE EXISTENCE OF WHICH ARE UNKNOWN TO DGT ASSOCIATES, INC. THE SIZE, LOCATION AND EXISTENCE OF ALL SUCH FEATURES MUST BE FIELD DETERMINED AND VERIFIED BY THE APPROPRIATE AUTHORITIES PRIOR TO ANY FUTURE CONSTRUCTION ACTIVITY. CALL BEFORE YOU DIG AT 811.
- THE SITE IS ZONED WRP-160 PER THE TOWN OF MONTVILLE ZONING MAP.
- 0 RIDGE HILL ROAD WAS INSPECTED BY R. RICHARD SNARSKI OF NEW ENGLAND ENVIRONMENTAL SERVICES ON MARCH 24, 2022 AND IT WAS DETERMINED THAT A WETLAND OR WATERCOURSE IS PRESENT AS NOTED HEREON IN THE AREA OF LOT DEVELOPMENT.
- THE AREA OF SITE DEVELOPMENT IS LOCATED IN ZONE X AS DEPICTED ON FEDERAL EMERGENCY MANAGEMENT AGENCY (FEMA) MAP 09011C0337G DATED 7-18-2011.
- SAID PARCEL IS TOGETHER WITH AND SUBJECT TO SUCH RIGHTS AS MAY APPEAR OF RECORD.

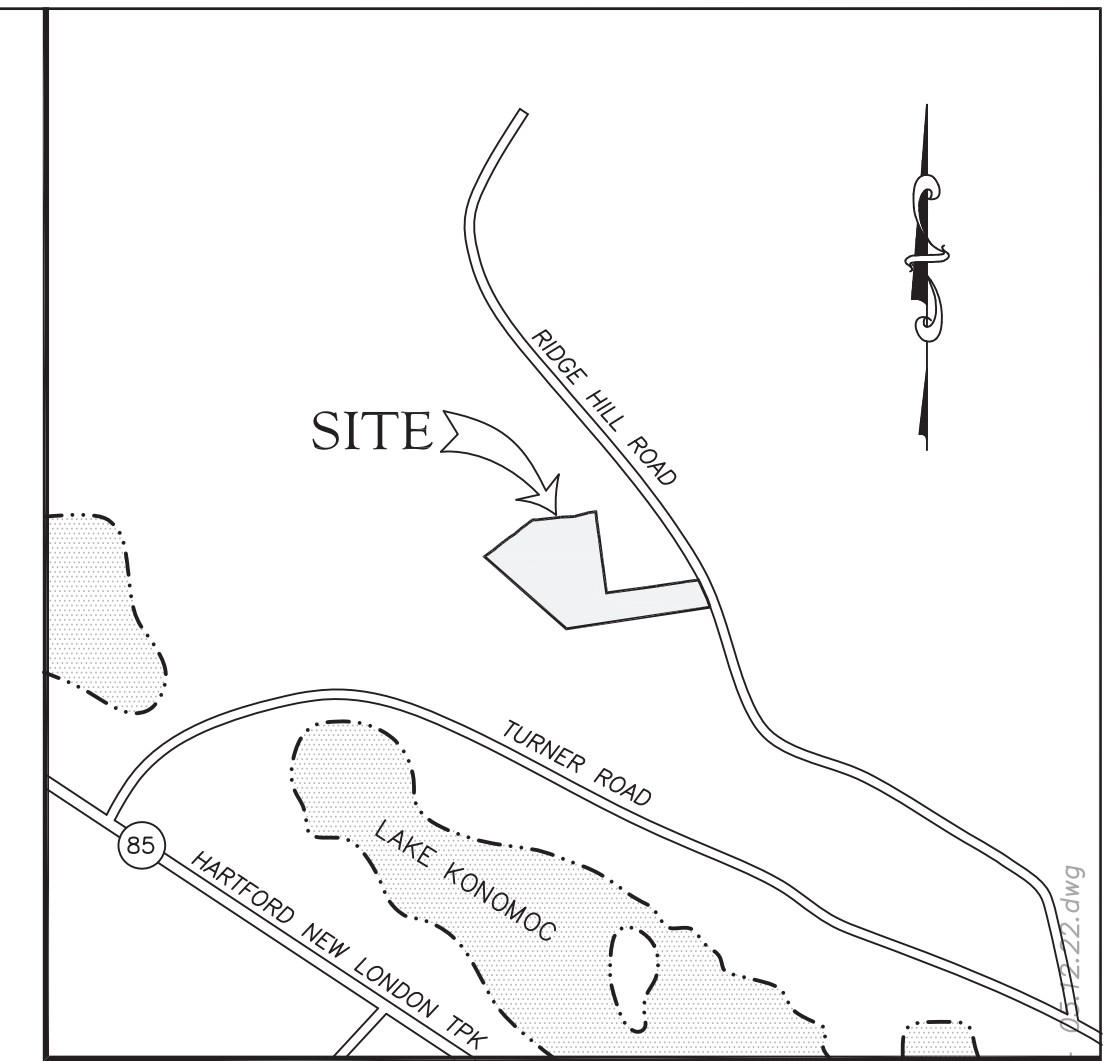

**LOCATION MAP**  
SCALE: 1"=1000'

