

LEGEND

±	MORE OR LESS
DH	DRILL HOLE
ELEV	ELEVATION
N/F	NOW OR FORMERLY
PROP	PROPOSED
(F)	FOUND
REF	REFERENCE
SNET	SOUTHERN NEW ENGLAND TELEPHONE
SF	SQUARE FEET
TYP	TYPICAL
— — — — —	BUILDING SETBACK LINE
- - - - -	EXIST CONTOUR LINE, 2' INTERVAL
- - - - -	EXIST CONTOUR LINE, 10' INTERVAL
●	IRON PIN OR DRILL HOLE
●	PROPERTY POINT
— — — — —	STONEWALL
~~~~~	EXISTING TREELINE
UT	UTILITY POLE
(W)	WELL
●	PERCOLATION TEST LOCATION
■	TEST HOLE LOCATION

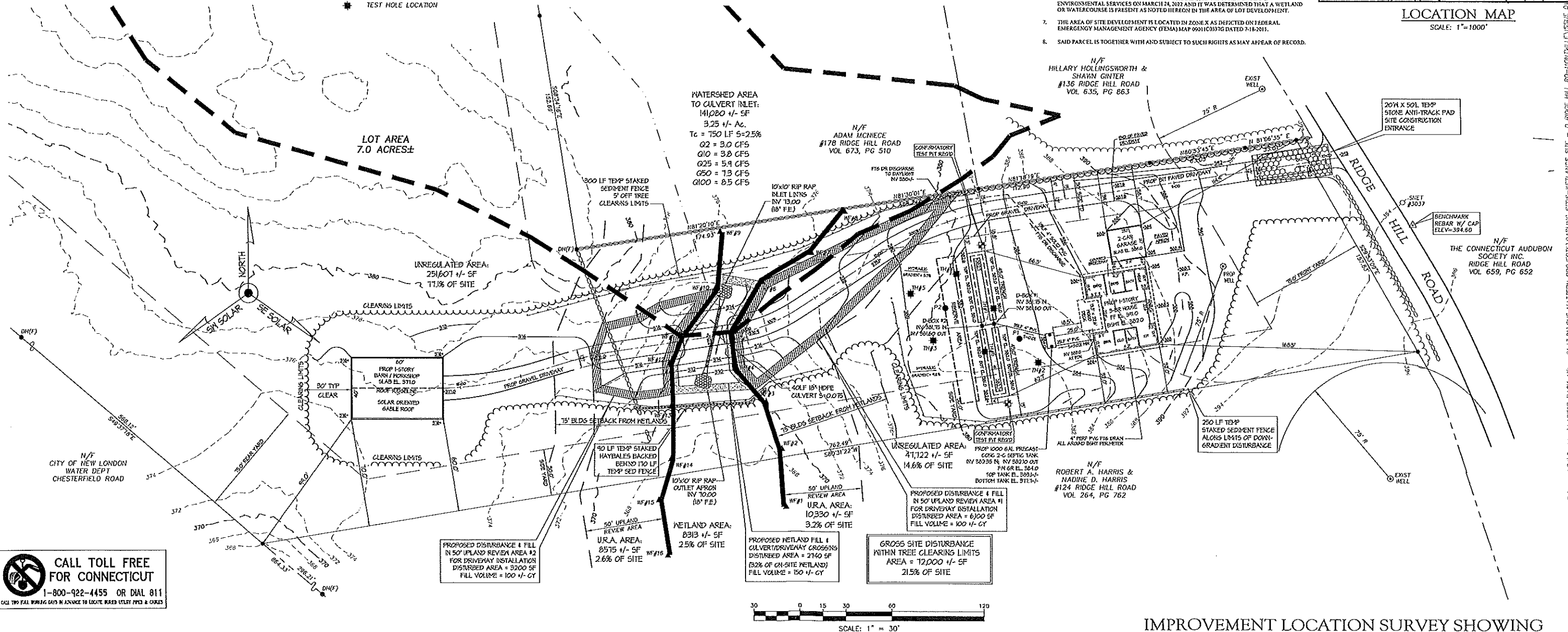

1. THIS MAP AND SURVEY HAVE BEEN PREPARED IN ACCORDANCE WITH SECTIONS 20-369B-1 THROUGH 20-369B-30 OF THE REGULATIONS OF CONNECTICUT STATE AGENCIES - MINIMUM STANDARDS OF ACCURACY, CONTENT AND CERTIFICATION FOR SURVEYS AND MAPS*, ADOPTED EFFECTIVE JUNE 21, 1984, REVISED OCTOBER 26, 2018. FOR THE PURPOSES OF THIS PROJECT, THE PROPOSED LOCATIONS WERE OBTAINED FROM THE AREA OF LOT DEVELOPMENT ONLY. IT IS AN "IMPROVEMENT LOCATION SURVEY" CONFORMING TO HORIZONTAL ACCURACY "CLASS A-2" STANDARDS. THE BOUNDARY DEGENERATION CATEGORY IS A "REFERENCE". REFERENCE MAY BE MADE TO NORTH AMERICAN DATUM OF 1983 (NAD 83). TOPOGRAPHIC INFORMATION DEPICTED HEREON CONFORMS TO TOPOGRAPHIC ACCURACY "CLASS T-2" STANDARDS. REFERENCE MAY BE MADE TO NORTH AMERICAN VERTICAL DATUM OF 1988 (NAVD83). THE PURPOSE OF THIS SURVEY IS TO DEPICT EXISTING CONDITIONS AND A PROPOSED RESIDENTIAL SITE PLAN.
2. REFERENCE MAY BE MADE TO THE FOLLOWING DEED RECORDED IN THE TOWN OF MONTEVILLE AND RECORDS:  
VOLUME: 646 PAGES: 438-490  
TYPE: CERTIFICATE OF DEVISE, DESCENT OR DISTRIBUTION  
GRANTOR: ESTATE OF KATHERINE M. DREEDEN A.K.A. KATHERINE M. NASON  
GRANTEE: LYNNIE KING  
DATE EXECUTED: 7-23-2019 DATE RECORDED: 7-22-2019
3. REFERENCE MAY BE MADE TO THE FOLLOWING PLANS:  
-RIDGE HILLS SUBDIVISION OF LAND OF FRANCIS WILLIAM FERRY, SR. MONTEVILLE, CONN. SCALE: 1"=100' DATE: 10-18-1965 SHEET 2 OF 2* PREPARED BY FREDERICK A. RADCLIFFE CONSULTING CIVIL ENGINEER. (TILED MAP 123)
4. UNDERGROUND UTILITY, STRUCTURE AND FACILITY LOCATIONS DEPICTED AND NOTED HEREON HAVE BEEN COMPILED, IN PART, FROM RECORD MAPING, PAROL TESTIMONY AND OTHER SOURCES. LOCATIONS OF UTILITIES ARE AS APPROXIMATE AS PRACTICABLE. ADDITIONALLY, OTHER SUCH FEATURES MAY EXIST ON THE SITE. THE EXISTENCE OF WHICH ARE UNKNOWN TO DQD ASSOCIATES, INC. THE SIZE, LOCATION AND EXISTENCE OF ALL SUCH UTILITIES MUST BE VERIFIED BY THE APPROPRIATE AUTHORITY PRIOR TO ANY FUTURE CONSTRUCTION ACTIVITY. CALL BEFORE YOU DIG AT 811
5. THE SITE IS ZONED WRP-160 PER THE TOWN OF MONTEVILLE ZONING MAP.
6. 0 RIDGE HILL ROAD WAS INSPECTED BY R. RICHARD SHASKOS OF NEW ENGLAND ENVIRONMENTAL SERVICES ON MARCH 24, 2021 AND IT WAS DETERMINED THAT A WETLAND OR WATERCOURSE IS PRESENT AS NOTED HEREON IN THE AREA OF LOT DEVELOPMENT.
7. THE AREA OF SITE DEVELOPMENT IS LOCATED IN ZONE X AS DEPICTED ON FEDERAL EMERGENCY MANAGEMENT AGENCY (FEMA) MAP 6901 C03137 DATED 7-18-2011.
8. SAID PARCEL IS TOGETHER WITH AND SUBJECT TO SUCH RIGHTS AS MAY APPEAR OF RECORD

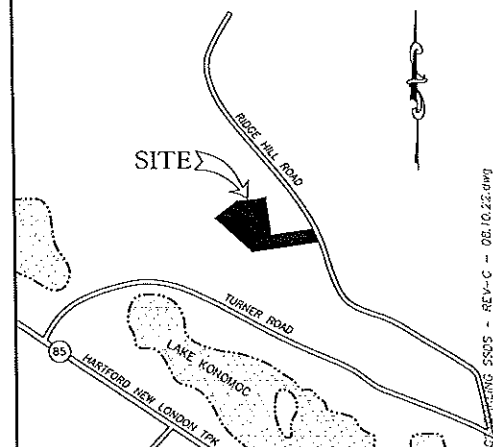

LOCATION MAP  
SCALE: 1"=1000'

 CALL TOLL FREE  
FOR CONNECTICUT  
1-800-922-4455 OR DIAL 811  
CALL TWO FULL WORKING DAYS IN ADVANCE TO LOCATE BURIED UTILITY PIPES & CABLES

PREPARED BY:

 **DGT Associates**  
Surveying &  
Engineering

**Preston, CT • Boston • Worcester  
Framingham**

148 CT-2, Preston, CT 06355  
860-899-1999 [www.DGTassociates.com](http://www.DGTassociates.com)

THIS DRAWING IS THE PROPERTY OF THE LAND SURVEYOR. THIS PLAN AND REPRODUCTIONS, ADDITIONS OR REVISIONS OF THIS PLAN ARE NOT VALID WITHOUT THE EMBOSSED SEAL AND SIGNATURE OF THE LAND SURVEYOR WHO PREPARED THIS PLAN.

"TO MY KNOWLEDGE AND BELIEF THIS MAP IS SUBSTANTIALLY CORRECT AS NOTED HEREON."

15157	
SUSAN F. MATTERN, PLS	LICENSE NO. DATE

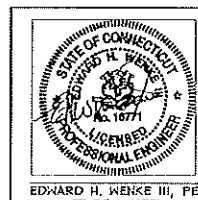

**EDWARD H. WENKE III, PE**  
**CIVIL - STRUCTURAL ENGINEER**  
 Licensed In : Connecticut, New York, Rhode Island, Maine  
 Massachusetts, Maryland, Pennsylvania, Wisconsin, California  
 P.O. Box 544 MUKWONAGO, WI 53149  
 Ph: 860.460.1605 Email: ewenke@comcast.net

REV-C: 08/10/22 - ADDED:  
 - 75' BLDG SETBACK FROM WETLANDS  
 - REV OUTBLDG TO SOLAR ORIENTATION  
 - REDUCED SILT FENCE LENGTHS  
 REV-B: 06/19/22 - ADDED:  
 - UNCAS HEALTH RWV COMMENTS;  
 - WETLANDS PERMIT COND OF APPROVAL  
 - REV BARN BLDG & DRIVEWAY TO HOUSE

ISSUE FOR CONSTRUCTION

IMPROVEMENT LOCATION SURVEY SHOWING  
PROPOSED SUBSURFACE SEWAGE DISPOSAL SYSTEM  
& PROPOSED WETLANDS DRIVEWAY CROSSING

PREPARED FOR  
LAWRENCE DARLING  
0 RIDGE HILL ROAD - OAKDALE  
MAP-BLOCK-LOT: 006-015-000  
MONTVILLE, CONNECTICUT

SCALE: 1"=30'    DATE: MAY 2022    JOB NO: C1089    SHEET 1 OF 3

## TEST PIT DATA

DEEP TEST PITS WERE WITNESSED BY MICHAEL J. KIRBY, R.S.,  
CHIEF ENVIRONMENTAL SANITARIAN, UNCAS HEALTH DISTRICT AND  
SUSAN F. WATTEH, DGT ASSOCIATES, INC. ON APRIL 13, 2022.

**TH#1**  
0'-8" TOPSOIL  
0'-32" LOAMY SUBSOIL  
32"-60" COMPACT GRAY FINE SAND/SILT, BOULDERS  
NOTHING: 32"  
GROUNDWATER: 67"  
LEDGE: NONE  
ROOTS: 36"  
RESTRICTIVE: 32"

**TH#2**  
0'-7" TOPSOIL  
7"-32" LOAMY SUBSOIL  
32"-78" FIRM TAN SAND, SOME SILT, ROCKS  
NOTHING: 32"  
GROUNDWATER: 63"  
LEDGE: NONE  
ROOTS: 53"  
RESTRICTIVE: 32"

**TH#3**  
0'-7" TOPSOIL  
7"-27" LOAMY SUBSOIL  
27"-84" MEDIUM SAND, ROCKS  
NOTHING: 32"  
GROUNDWATER: 63"  
LEDGE: NONE  
ROOTS: 48"  
RESTRICTIVE: 35"

**TH#4**  
0'-7" TOPSOIL  
7"-33" LOAMY SUBSOIL  
33"-59" MEDIUM SAND & GRAVEL, ROCKS  
NOTHING: 33"  
GROUNDWATER: 52"  
LEDGE: NONE  
ROOTS: 35"  
RESTRICTIVE: 33"

**TH#5**  
0'-6" TOPSOIL  
6"-35" LOAMY SUBSOIL  
35"-85" FIRM TAN SAND, SOME SILT, ROCKS  
NOTHING: 27"  
GROUNDWATER: 63"  
LEDGE: NONE  
ROOTS: 32"  
RESTRICTIVE: 27"

**TH#6**  
0'-9" TOPSOIL  
9"-34" LOAMY SUBSOIL  
34"-87" MEDIUM SAND, TRACE OF SILT, ROCKS  
NOTHING: 34"  
GROUNDWATER: NONE  
LEDGE: NONE  
ROOTS: 24"  
RESTRICTIVE: 34"

**SANITARIAN'S NOTES & SPECIAL CONDITIONS**  
GROUNDWATER TABLE BELOW MAXIMUM  
PROBABLE HIGH GROUNDWATER  
OPEN WATERCOURSE OR WETLANDS  
SUITABLE FOR SEWAGE DISPOSAL  
UNDESIGNED ENGINEERED PLAN REQUIRED  
AVERAGE RESTRICTIVE LAYER 32.7"

## PERCOLATION TEST DATA

Soil Test Results - Lawrence Darling - 0 Ridge Hill Road, Montville, CT

## PERCOLATION TEST HOLE 1

PRESOAK 1:20 PM ON 4-12-2022 (NOT DRY AFTER PRESOAK)  
DEPTH - 32" FROM EXISTING GRADE  
DATE OF TEST: 4-12-2022

TIME	READING
2:25 PM	31"
2:30 PM	64"
2:35 PM	84"
2:40 PM	91"
2:45 PM	118"
2:50 PM	123"
2:55 PM	138"
3:00 PM	145"
3:05 PM	154"
3:10 PM	161"
3:15 PM	173"
3:20 PM	173"
3:25 PM	173"

PERCOLATION RATE: 8.7 MINUTES/INCH

## PERCOLATION TEST HOLE 2

PRESOAK 1:15 PM ON 4-12-2022 (NOT DRY AFTER PRESOAK)  
DEPTH - 30" FROM EXISTING GRADE  
DATE OF TEST: 4-12-2022

TIME	READING
2:20 PM	8"
2:25 PM	10"
2:30 PM	11 1/2"
2:35 PM	12 1/2"
2:40 PM	14 1/2"
2:45 PM	16"
2:50 PM	17 1/2"
2:55 PM	18"
3:00 PM	19"
3:05 PM	19 1/2"
3:10 PM	20 1/2"
3:15 PM	21"
3:20 PM	21 1/2"

PERCOLATION RATE: 8.0 MINUTES/INCH

PREPARED BY:

**DGT Associates**  
Surveying & Engineering  
Preston, CT • Boston • Worcester  
Framingham

148 CT-2, Preston, CT 06365  
860-899-1999 www.DGTassociates.com

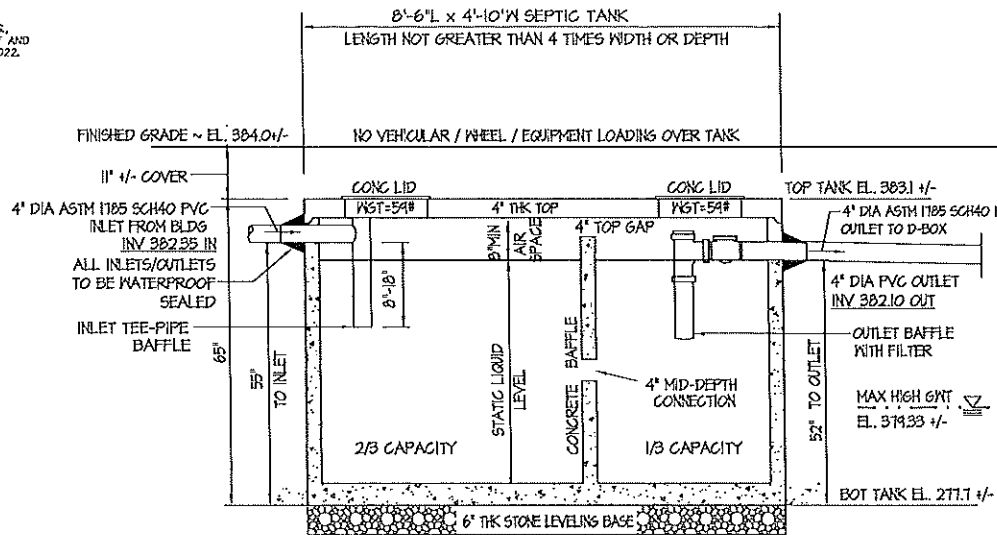

## 1000 GALLON SEPTIC TANK DETAIL

- EXTERIOR OF TANK & ALL SEAMS TO BE COATED WITH WATERPROOFING; ALL SEAMS TO BE WATERTIGHT BUTYL RUBBER GASKETTED.
- NOT H-20 LOAD RATED - NO WHEEL LOADS ALLOWED OVER TANK
- TANK ANTI-BUOYANCY COLLAR NOT REQUIRED.
- CONTRACTOR TO SHORE & DE-WATER EXCAVATED HOLE AS REQ'D

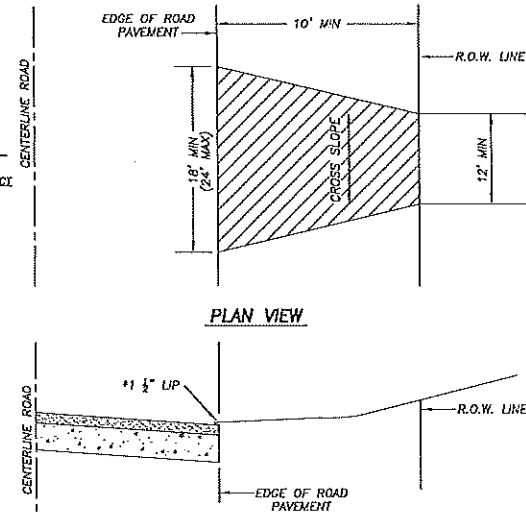

NOTE:

- SAW CUT IRREGULAR PAVEMENT EDGE TO MATCH DRIVEWAY APRON.
- PROVIDE 1 1/2 INCH LIP ONLY ON APRONS THAT ADJUT ROADS THAT ARE CURBED

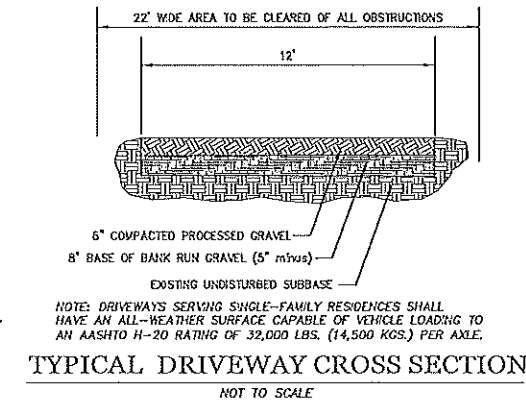

NOTE: DRIVEWAYS SERVING SINGLE-FAMILY RESIDENCES SHALL HAVE AN ALL-WEATHER SURFACE CAPABLE OF VEHICLE LOADING TO AN AASHTO H-20 RATING OF 32,000 LBS. (14,500 KGS.) PER AXLE.

TYPICAL DRIVEWAY CROSS SECTION

NOT TO SCALE

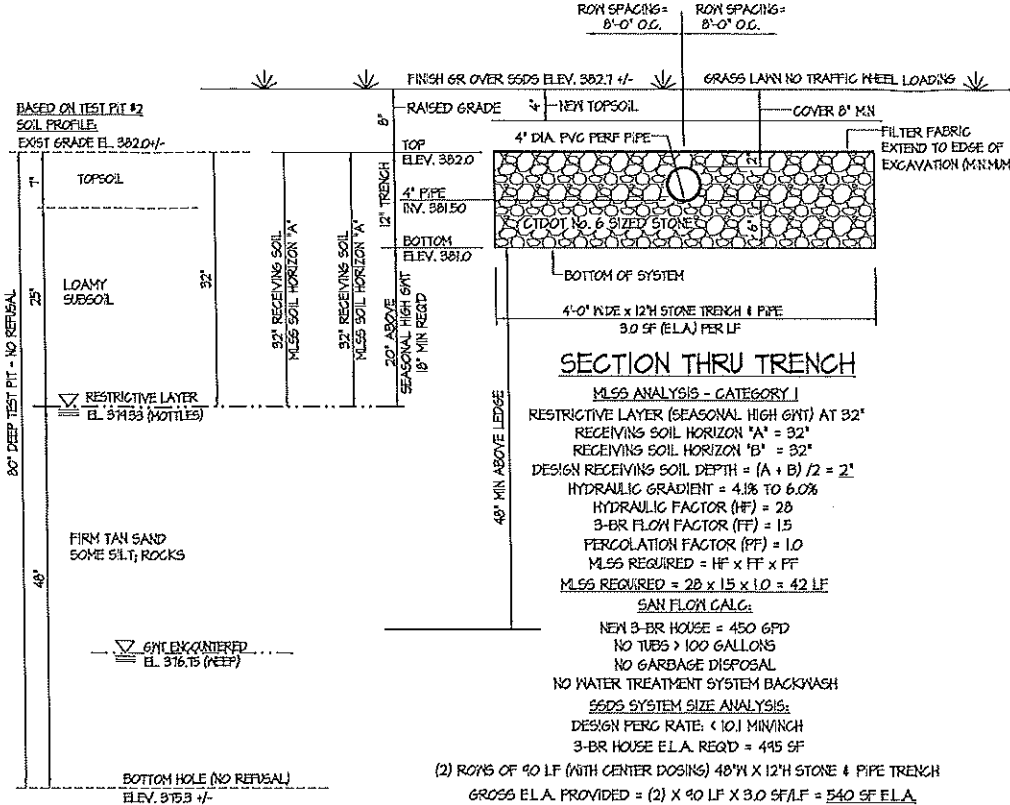

## SECTION THRU TRENCH

**CLASS ANALYSIS - CATEGORY I**  
RESTRICTIVE LAYER (SEASONAL HIGH GWT) AT 32"  
RECEIVING SOIL HORIZON 'A' = 32"  
RECEIVING SOIL HORIZON 'B' = 32"  
DESIGN RECEIVING SOIL DEPTH = (A + B) / 2 = 32"  
HYDRAULIC GRADIENT = 4.1% TO 6.0%  
HYDRAULIC FACTOR (HF) = 28  
3-BR FLOW FACTOR (FF) = 15  
PERCOLATION FACTOR (PF) = 1.0  
MSS REQUIRED = HF x FF x PF  
MSS REQUIRED = 28 x 15 x 1.0 = 42 LF  
**SAN FLOW CALC:**  
NEW 3-BR HOUSE = 450 GPD  
NO TUBS > 100 GALLONS  
NO GARBAGE DISPOSAL  
NO WATER TREATMENT SYSTEM BACKWASH  
**SEDS SYSTEM SIZE ANALYSIS:**  
DESIGN PERG RATE: < 1.0 MIN/INCH  
3-BR HOUSE E.L.A. REQ'D = 445 SF

(2) ROWS OF 90 LF (WITH CENTER DOSING) 48" X 12" STONE & PIPE TRENCH  
GROSS E.L.A. PROVIDED = (2) x 90 LF x 3.0 SF/LF = 540 SF E.L.A.  
GROSS E.L.A. PROVIDED = 540 SF E.L.A. > 445 SF REQ'D ~ E.L.A. COMPLIANT ~ OK.  
LENGTH OF TRENCH = 90 LF > 42 LF REQ'D ~ MSS COMPLIANT ~ OK.

## SEPTIC TANK OUTLET EFFLUENT FILTER SIZING:

Q = 450 GPD  
EFFLUENT FILTER SHOULD BE INSPECTED/CLEANED ANNUALLY.  
MTEG = 2 YEARS (ASSUMED ACTUAL TIME BETWEEN CLEANINGS - CONSERVATIVE)  
A1 = 0.0002 x Q x MTEG = 0.0002 x 450 x 2 = 0.18 FT  
MIN FILTER AREA REQUIRED = 1.8 FT  
**SELECT ORANGE 4" DIA BIO-TYPE FILTER FTO436-20 OR APPYD EQUAL**  
PROVIDE SUPPORT BRACKET TO INTERIOR TANK WALL.

## HEALTH CODE REFERENCE:

THIS DESIGN INCLUDES ALL MATERIALS, SETBACKS & INSTALLATION SHALL BE IN ACCORDANCE WITH THE STATE OF CT D.O.H. PUBLIC HEALTH CODE P.H.C. SECT. 19-13-B103 INCLUDING THE ON-SITE SEWAGE DISPOSAL REGULATIONS & TECHNICAL STANDARDS FOR SUBSURFACE SEWAGE DISPOSAL SYSTEMS (DESIGN FLOWS 5000 GPD OR LESS); EFFECTIVE DATE: 08/01/1982 AND REVISED THRU 01/01/2018.

## 06/03/22 UNCAS HD CONDITIONS OF APPROVAL:

- ENDS OF THE TRENCHES SHALL BE CONNECTED.
- PRIOR TO CONSTRUCTION:
- PERFORM CONFIRMATORY SOIL TEST PITS WITH UND SANITARIAN.
- THE HOUSE, WELL, & SEDS SYSTEM SHALL BE STAKED BY A LICENSED LAND SURVEYOR.
- A BENCHMARK SHALL BE SET IN THE AREA OF THE SEDS SYSTEM

## CONFIRMATORY TEST HOLES REQUIRED:

INSTALLER SHALL SCHEDULE WITH HEALTH DISTRICT AND PERFORM AT LEAST TWO (2) SOIL TEST PITS (ONE ON EACH END OF ACTUAL SYSTEM LOCATION) TO CONFIRM SOIL CONDITIONS, SEASONAL HIGH GROUNDWATER TABLE & DEPTHS TO REFUSAL TO AT LEAST 4" BELOW LEACHING SYSTEM BOTTOM. IF ANY CONDITIONS ARE ENCOUNTERED THAT ARE DIFFERENT FROM THE DESIGN BASIS SHOWN HEREON, THE ENGINEER SHOULD BE CONTACTED FOR REVIEW AND REVISION TO THIS PLAN SET AS MAY BE REQUIRED.

## POST-INSTALLATION AS-BUILT REQUIREMENTS

INSTALLER SHALL SUBMIT SCALED AND/OR TIED AS-BUILTS TO THE UNCAS HEALTH DISTRICT SANITARIAN OFFICIAL WITHIN 30 DAYS OF COMPLETION WITH DISTANCES TO FLOW LINE AT THE HOUSE, INLET AND OUTLET COVER OF TANK, D-BOX, CLEAN-OUTS AND ENDS OF LEACHING ROWS, WELL, FOOTING/CURTAIN DRAINS (AS APPLICABLE) & BETWEEN THE POINTS. PROVIDE NAME OF INSTALLER, DATE, HOUSE LOCATION, STREET ADDRESS & DIRECTIONAL NORTH ARROW.

## HEALTH DEPT JURISDICTION:

UNCAS HEALTH DISTRICT  
401 WEST THAMES STREET, SUITE 106  
NORWICH, CONNECTICUT 06260  
TEL. (860) 823-1094

## SANITARY SYSTEM NOTES

- ALL UTILITIES SHOWN OR REFERRED TO IN THIS PLAN ARE APPROXIMATE AND MUST BE VERIFIED BY THE CONTRACTOR PRIOR TO ANY SITE CONSTRUCTION. THE CONTRACTOR SHALL NOTIFY "CALL BEFORE YOU DIG" AT 1-800-422-4455 OR 811 AT LEAST THREE (3) BUSINESS DAYS PRIOR TO ANY EXCAVATION.
- THE CONTRACTOR SHALL STRIP ALL TOPSOIL TO 5' BEYOND THE LIMITS OF ANY FILLING FOR THE PROPOSED SYSTEM. THE STRIPPED TOPSOIL SHALL BE STOCKPILED ON-SITE, IN AN AREA NOT IN WAY OF CONSTRUCTION. PRIOR TO RE-USE OF TOPSOIL, IT IS RECOMMENDED TO SCREEN THE TOPSOIL FOR REDISTRIBUTION. SECURE ALL NECESSARY PERMITS FOR SCREENING AS REQUIRED. THE TOP OF THE STOCKPILE SHALL BE PROTECTED FROM EROSION/SEDIMENTATION BY INSTALLING A ROW OF STAKED HAYBALES OR AN APPROVED SEDIMENT FENCE ALL AROUND THE BASE OF THE STOCKPILE. THE CONTRACTOR SHALL SEED THE STOCKPILE WITH RYE GRASS OR EQUAL IF IT IS TO BE LEFT FOR A PERIOD EXCEEDING 120 DAYS.
- THE BOTTOM OF THE LEACHING FIELD EXCAVATION SHALL BE LEVEL, SCARIFIED AND PREPARED IN ACCORDANCE WITH THE "CONNECTICUT PUBLIC HEALTH CODE, REGULATIONS & TECHNICAL STANDARDS FOR SUBSURFACE SEWAGE DISPOSAL SYSTEMS, LATEST REVISION, WHICH SHALL BE A PART OF THIS PLAN.
- NOT LATER THAN TWO (2) DAYS AFTER INSTALLATION OF LEACHING SYSTEM HAS BEEN INSPECTED & APPROVED BY THE LOCAL SANITARIAN, THE CONTRACTOR SHALL BACKFILL THE SYSTEM AS SHOWN ON THE PLAN.
- CONTRACTOR SHALL REDISTRIBUTE THE TOPSOIL TO A MINIMUM DEPTH OF FOUR (4) INCHES, GRADE THE FINISHED SURFACES TO DRAIN AND TO PREVENT EROSION/SEDIMENTATION AND FLOODING.
- THE AREA OF SITE DISTURBANCE IS APPROXIMATELY 12,000 +/- S.F. THE CONTRACTOR SHALL TAKE ALL NECESSARY PRECAUTIONS TO PREVENT SOIL EROSION AND/OR SEDIMENTATION FROM THE EXPOSED EXCAVATION. AS SUCH THE CONTRACTOR SHALL USE THE "STATE OF CONNECTICUT GUIDELINES FOR SOIL EROSION AND SEDIMENT CONTROL" LATEST REVISION, AS A GUIDE FOR METHODS OF SOIL LOSS PREVENTION, WHICH SHALL BE A PART OF THIS PLAN.
- THE CONTRACTOR SHALL NOTIFY THE ENGINEER IMMEDIATELY UPON ANY DISCOVERY OF SITE CONDITIONS NOT ADDRESSED BY THIS PLAN. THE CONTRACTOR SHALL NOT DEVIATE FROM THIS PLAN WITHOUT THE WRITTEN PERMISSION OF THE ENGINEER, MUNICIPAL STAFF AND THE LOCAL SANITARIAN.
- THE NEW SEPTIC TANK SHALL BE PRECAST CONCRETE CONSTRUCTION WITH THE FOLLOWING MINIMUM REQUIRED SPECIFICATIONS:  
- 1000 GALLON 2-COMPARTMENT CONC SEPTIC TANK, NON-H-20 RATED.  
- TANK NOT REQUIRED TO BE ANCHORED TO PREVENT BUOYANCY.  
- TANK TO BE COATED WITH APPYD WATERPROOFING MASTIC COATINGS.  
- TANK TO HAVE 54" CONC ACCESS LIDS OR EQUAL, TO REMAIN IN-PLACE.
- ALL ROOF DRAIN DISCHARGES SHALL BE PIPED AWAY FROM THE NEW SEDS AND DISCHARGED VIA CLOSED PIPE SYSTEM OFF-SITE.
- BUILDING SEWER LINE FROM THE FDN TO THE SEPTIC TANK: ASTM A105 SCH40 PVC WITH 2-STEP PVC SOLVENT WELDED TIGHT JOINTS.  
GRAVITY SOLID WASTE PIPE TO SEPTIC TANK SHALL BE SOLID PIPE WITH A MIN GRAVITY SLOPE OF 1/4" PER FOOT (2.0%) LAID TRUE WITH NO LOW POINTS OR "BELLIES". ALL OTHER GRAVITY EFFLUENT DISTRIBUTION PIPING FROM TANK SHALL HAVE GRAVITY SLOPE OF 1.0% MINIMUM (OR AS SHOWN) WITH NO LOW POINTS OR "BELLIES".

- REFER TO THE ARCHITECTURAL PLANS (BY OTHERS) FOR EXACT BUILDING FOOTPRINT CONFIGURATION, SIZE AND LAYOUT.
- ALL DISTURBED AREAS NOT COVERED BY DRIVEWAYS, BUILDINGS OR WALKS SHALL BE PLANTED WITH 4" MIN. LAYER OF TOPSOIL, LIMED, FERTILIZED, SEEDING AND MULCHED FOR A GRASS LAWN.
- FINAL GRADED SURFACE SHALL DIRECT DRAINAGE AWAY FROM THE LEACHING SYSTEM. FINAL GRADES SHALL NOT EXCEED 8:1 (HORIZ:VERTICAL).
- ALL SELECT SEPTIC FILL TO BE USED AROUND THE SYSTEM SHALL BE AN APPROVED SELECT BACKFILL - SAND & GRAVEL CONFORMING TO SECT. VIII(A) OF THE CT. PUBLIC HEALTH CODE TECHNICAL STANDARDS LATEST EDITION; AS FOLLOWS:  
A. FILL SHALL NOT CONTAIN MATERIAL LARGER THAN 2".  
B. UP TO 45% OF THE DRY WEIGHT OF THE REPRESENTATIVE SAMPLE MAY BE RETAINED ON THE #40 SIEVE (GRAVEL PORTION OF SAMPLE)  
C. MATERIAL THAT PASSES THE #40 SIEVE IS RE-WEIGHED, AND THE GRADATION ANALYSIS STARTED.  
D. THE REMAINING SAMPLE SHALL MEET THE FOLLOWING CRITERIA:  

SIEVE SIZE	PERCENT PASSING
#4	100%
#10	10% - 100%
#40	10% - 50%
#100	0% - 20%
#200	0% - 5%
- SELECT FILL SHALL BE PERC TESTED IN-PLACE PRIOR TO 65T INSTALLATION & SHALL NOT BE SLOWER THAN 100 MIN/INCH.
- THE NEW SEPTIC TANK, D-BOXES PIPING & LEACH FIELD ARE LOCATED BELOW A LAWN. NO VEHICLE WHEEL DRIVEWAY & PARKING ARE PROPOSED OVER LEACHING FIELD.
- AREA FOR STRIPPING AND FILLING SHALL EXTEND A MINIMUM OF 5 FT ALL AROUND BEYOND THE EDGE OF THE PROPOSED SEDS LEACH FIELD. STRIPPED SOIL SHALL BE REMOVED FROM SITE.
- DEPTH OF STRIP SHALL BE TO THE BOTTOM OF TRENCH SHOWN HEREON. SCARIFY STRIPPED SURFACE BEFORE INSTALLING SELECT GRAVEL FILL.
- THE SEWAGE CONTRACTOR SHALL OBTAIN AN INSTALLATION PERMIT IN ADVANCE OF INITIATING ANY WORK ON THE SEWAGE SYSTEM AREA, IN ORDER TO COORDINATE THE NECESSARY INSPECTIONS, INCLUDING STAKE-OUT, STRIPPING, FILL MATERIAL APPROVAL, FILLING AND COMPONENT INSTALLATION.
- ANY EXTERIOR DECK OR ACCESSORY STRUCTURES WITHOUT FOUNDATION FOUNDATIONS SHALL BE LOCATED AT LEAST 5 FT FROM ANY PART OF THE SEPTIC SYSTEM INCLUDING THE SEPTIC TANK AND LEACHING FIELD.
- ALL GROUNDWATER/ROOF DRAIN WATER COLLECTION PIPES WITHIN 25' OF SEDS SYSTEM SHALL BE MADE OF TIGHT SDR35 PVC PIPE WITH TIGHT GASKETTED JOINTS AND SHALL NOT HAVE ANY FREE-DRAINING MATERIAL (FDM) FOR BEDDING OR BACKFILL. KNOW ID SEPARATES DISTANCE FROM TIGHT PIPE TO ANY PART OF SEDS SYSTEM.
- 100% RESERVE SYSTEM AREA IS PROVIDED.

## APPLICANT:

LAWRENCE J. DARLING JR.  
61 MOSTOWN ROAD  
EAST LYME, CT 06333  
Tel: (860) 304-0556

## ENGINEER OF RECORD:

EDWARD H. WENKE III, PE  
CONS. P.E. # 16771  
P.O. BOX 544  
MUKWONAGO, WI 53144  
TEL. (860) 460-1606

## NOTES &amp; DETAILS

PREPARED FOR

**LAWRENCE DARLING**  
0 RIDGE HILL ROAD - OAKDALE  
MAP-BLOCK-LOT: 006-015-000  
MONTVILLE, CONNECTICUT

SCALE: AS NOTED DATE: MAY 2022 JOB NO: C1089 SHEET 2 OF 3

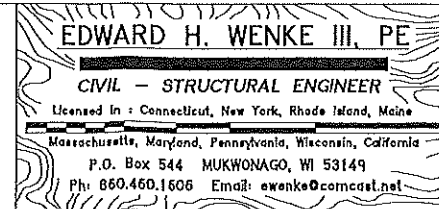
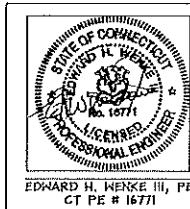

REV-C: 08/10/22

- NO CHANGES THIS SHEET

REV-B: 06/19/22 - ADDED:

- UNCAS HEALTH RW COMMENTS;
- WETLANDS PERMIT COND OF APPROVAL
- REV BARN BLDG & DRIVEWAY TO HOUSE

ISSUE FOR CONSTRUCTION



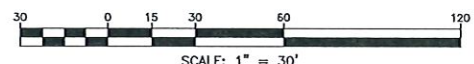
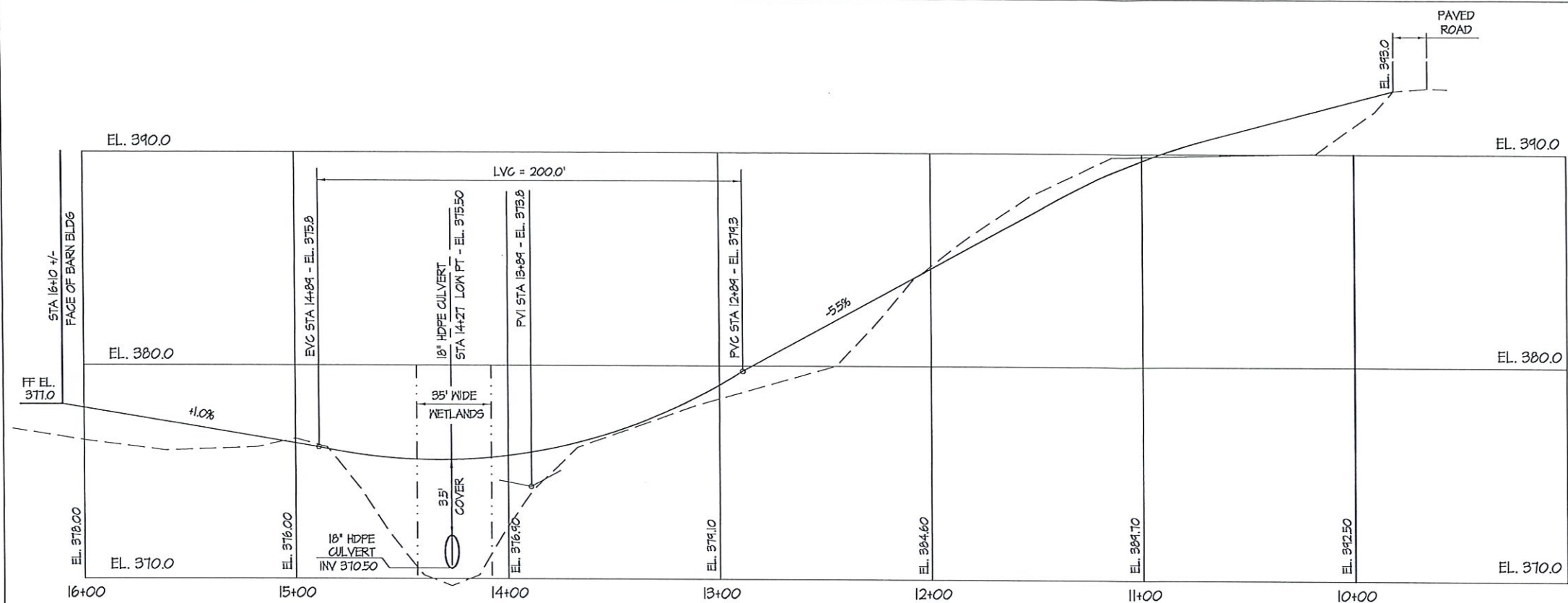

DRIVEWAY PROFILE  
SCALE: 1" = 30' (HORIZONTAL)  
SCALE: 1" = 3' (VERTICAL)

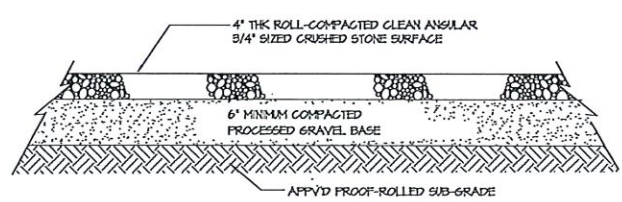

STONE SURFACE DRIVEWAY SECTION

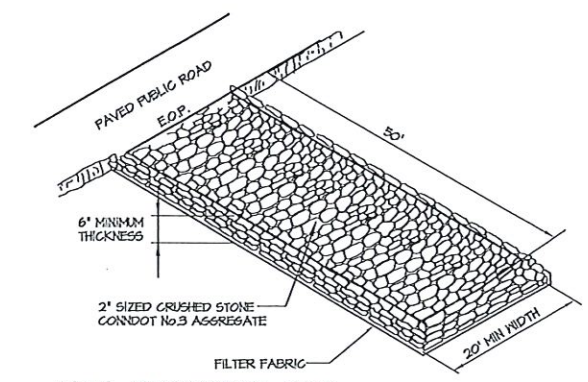

ANTI-TRACKING PAD  
CONSTRUCTION EXIT DETAIL

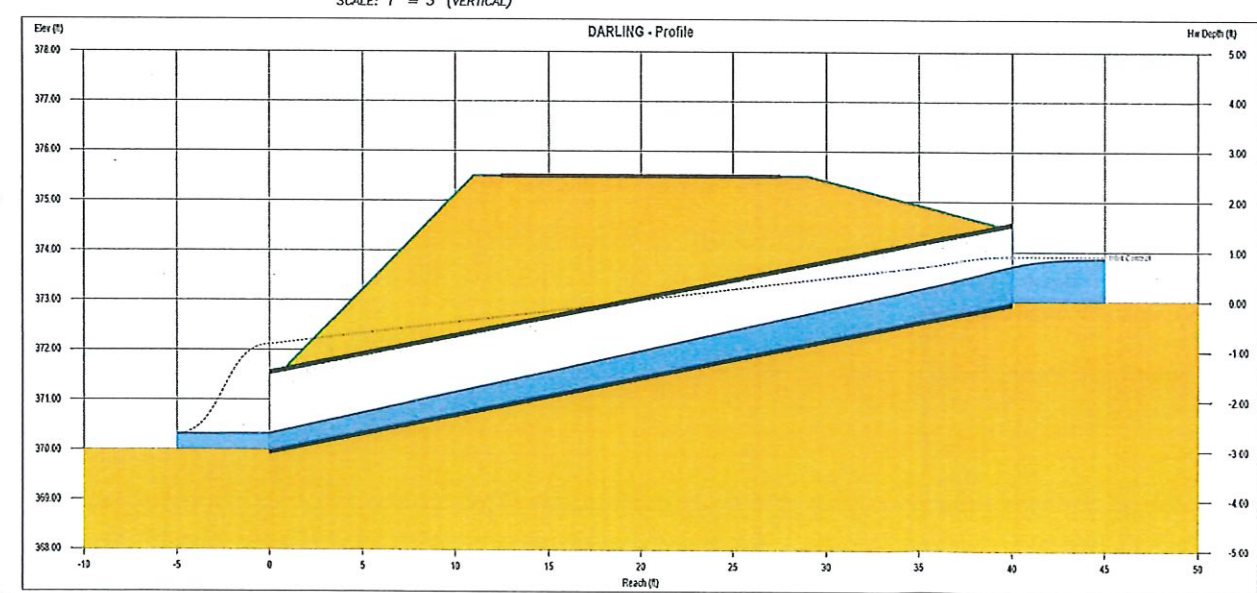

CULVERT SECTION  
SCALE: NONE

STABILIZATION NOTES

- 5-1) ALL DISTURBED AREAS NOT COVERED BY BUILDINGS, DRIVEWAYS, ROADWAYS, OR MULCHED PLANTING BEDS SHALL BE GRADED AND STABILIZED AS FOLLOWS:
  - a. PLACE A MINIMUM OF 4 INCHES OF TOPSOIL IN ALL AREAS. APPLY LESTERITE AND FERTILIZER IN ACCORDANCE WITH TEST RECOMMENDATIONS.
  - b. APPLY RECOMMENDED SEED MIXTURE AT RECOMMENDED RATE.
  - c. APPLY STRAW OR HAY MULCH ON ALL SEEDED AREAS.
  - d. SEEDING SHALL TAKE PLACE BETWEEN APRIL 1 AND JUNE 15, OR SEPTEMBER 15 AND OCTOBER 30. SEEDING DURING THESE TIME FRAMES SHALL APPLY STRAW OR HAY MULCH AT A RATE OF 2 BALES PER 1000 SF. IF THE SEEDING IS APPLIED OUTSIDE OF THESE TIMEFRAMES, THE AREAS SHALL BE STABILIZED WITH STRAW OR HAY MULCHING @ A RATE OF 40 LBS/1000 SF.
- 5-2) ALL AREAS THAT HAVE BEEN DISTURBED BY CONSTRUCTION ARE TO BE SEEDED WITH TUTTURA 2000[®] BY THE CHAS. C. HART CO., CONTAINING THE FOLLOWING VARIETIES OF PERENNIAL GRASSES: FIESTA II, BLAZER II, DASSER II AND EXPRESS. A SEEDING RATE OF 5-7 LBS PER ACRE IS RECOMMENDED.
- 5-3) GRADED AREAS STEEPER THAN 3:1 SHALL BE SEEDED WITH REED CANARY GRASS (0.45 LBS/1000 SF) AND REDTOP (0.10 LBS/1000 SF); OR TOWN ENGINEER APPROVED EQUAL; AND STABILIZED WITH JUTE NETTING.
- 5-4) MULCHING SHALL BE APPLIED IN THE FOLLOWING MANNER: SPREAD MULCH BY HAND OR MULCH BLOWER, PUNCH MULCH INTO SOIL SURFACE WITH TRACK MACHINE APPROXIMATELY 2" - 3" TO ANCHOR INTO SOIL.
- 5-5) WHEN ALL AREAS ARE STABILIZED, REMOVE ALL EROSION AND SEDIMENT CONTROL DEVICES AND DISPOSE OF ALL ACCUMULATED SEDIMENTS AT A PRE-APPROVED LOCATION.
- 5-6) ALTERNATE STABILIZATION MEASURES FOR SMALLER GRASEED AREAS MAY INCLUDE INSTALLATION OF AN APPROVED GRASS SOD/MRF.

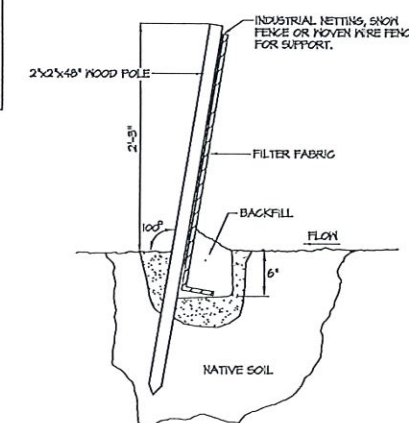

SEDIMENT FENCE DETAIL

SOIL EROSION & SEDIMENT CONTROL NOTES

- 3-1) DISTURBANCE OF SOIL SURFACES IS REGULATED BY LOCAL & STATE LAW. ALL WORK SHALL COMPLY WITH THE FOLLOWING CRITERIA TO PREVENT OR MINIMIZE SOIL EROSION AND/OR SEDIMENTATION.
- 3-2) THE INSTALLATION & CONTINUOUS MAINTENANCE OF EROSION CONTROL DEVICES IS THE RESPONSIBILITY OF THE PROJECT SITE CONTRACTOR.
- 3-3) THE CONTRACTOR SHALL USE THE CONNECTICUT GUIDELINES FOR SOIL EROSION AND SEDIMENT CONTROL - 2002, OR LATEST REVISION, WHICH SHALL BECOME A PART OF THIS PLAN. THE GUIDELINES MAY BE OBTAINED FROM THE CONNECTICUT PUBLICATIONS BOOK STORE, HARTFORD, CT.
- 3-4) THE CONTRACTOR SHALL INFORM ALL CONSTRUCTION SITE WORKERS ABOUT THE MAJOR PROVISIONS OF THE EROSION CONTROL PLAN AND SHALL REQUIRE THEIR COOPERATION IN AVOIDING THE DISTURBANCE OR DAMAGE TO THESE MEASURES.
- 3-5) THE CONTRACTOR SHALL BE RESPONSIBLE FOR THE TIMELY INSTALLATION, INSPECTION AND REPAIR OR REPLACEMENT OF EROSION CONTROL DEVICES TO ENSURE PROPER OPERATION.
- 3-6) THE CONTRACTOR SHALL INSPECT AND REPAIR EROSION AND SEDIMENT CONTROL DEVICES AT THE END OF EACH WORKING DAY AND AFTER EACH STORM.
- 3-7) THE CONTRACTOR SHALL RESTORE DISTURBED AREAS AS CLOSELY AS POSSIBLE TO THEIR ORIGINAL CONDITION.
- 3-8) THE CONTRACTOR SHALL NOTIFY LAWRENCE J. DARLING HEREINAFTER REFERRED TO AS THE OWNER, OF ANY UNSATISFACTORY EROSION OR SEDIMENTATION CONDITIONS NOT CONTROLLED BY THIS PLAN AS THEY MAY ARISE, AND SHALL INSTALL ADDITIONAL MEASURES AS MAY BE DIRECTED BY THE MUNICIPALITY. THE OWNER MAY BE CONTACTED AT 860-304-0556 TO REPORT ANY EMERGENCY SEEC SITE CONDITIONS.
- 3-9) FIELD CHANGES TO THIS PLAN SHALL BE MADE ONLY WITH THE WRITTEN CONSENT OF THE ENGINEER AND/OR THE MUNICIPAL LAND USE AGENCY.
- 3-10) ACCUMULATED SEDIMENT REMOVED FROM EROSION CONTROL DEVICES SHALL BE CLEANED REGULARLY AND REMOVED FROM SITE OR RE-USED IN NON-STRUCTURAL PLANTING AREAS ON-SITE AS MAY BE APPROVED BY ENGINEER.
- 3-11) ALL DISTURBED AREAS NOT COVERED WITH IMPERVIOUS SURFACES, BUILDINGS OR MULCH SHALL BE PLANTED WITH GRASS ON 4" MIN. THICKNESS TOPSOIL LAYER AND PROTECTED WITH MULCH ANCHORING.
- 3-12) REFER TO STABILIZATION NOTES SHOWN ON THIS SHEET.
- 3-13) MULCHING: IMMEDIATELY FOLLOWING SEEDING, MULCH THE SEEDED SURFACE WITH STRAW OR HAY AT A RATE OF 2 BALES PER 1000 SF. SPREAD MULCH BY HAND OR MULCH BLOWER. PUNCH MULCH INTO SOIL SURFACE WITH TRACK MACHINE APPROXIMATELY 2" TO 3" TO ANCHOR SECURELY INTO SOIL.
- 3-14) ANY EXISTING OR PROPOSED STORMWATER DRAINAGE STRUCTURES WHICH MAY BE SUBJECT TO SEDIMENTATION, INCLUDING CATCH BASINS/GRATES, INLET/OUTLET STRUCTURES AND OUTFALL AREAS SHALL BE PROTECTED THROUGHOUT THE ENTIRE CONSTRUCTION PERIOD. THE CONTRACTOR SHALL ENSURE THAT ANY DAMAGE, SEDIMENTATION OR OTHER CONSTRUCTION RELATED DEERIS SHALL BE REMOVED, CLEANED AND/OR REPAIRED FOR ALL COMPONENTS OF ANY STORM DRAIN OR OTHER PROPERTIES AFFECTED BY THIS PROJECT.
- 3-15) ALL HAYBALES SHALL BE TOED INTO EXISTING SUBSTRATE SOILS AND STABILIZED WITH STURDY STAKES (TWO PER BALE).
- 3-16) ALL TEMPORARY SOIL STOCKPILE AREAS SHALL BE PROTECTED WITH A ROW OF HAYBALES OR SEDIMENT FENCE AROUND THE TOE AND SPREAD HAY MULCH AND MOVEN NETTING (OR EXCELISIOR EROSION CONTROL MATTING) WHEN LEFT EXPOSED FOR LONGER THAN (30) CALENDAR DAYS.
- 3-17) UPON PROJECT COMPLETION, ALL DISTURBED AREAS OTHER THAN THOSE SPECIFIED ON THE SITE PLANS, SHALL BE TREATED WITH AN APPROPRIATE SEED MIX TO ENSURE PERMANENT STABILIZATION. ALL TEMPORARY SEEC CONTROLS SHALL BE MAINTAINED UNTIL EXPOSED SOILS ARE SATISFACTORILY STABILIZED.
- 3-18) SCHEDULE AN INSPECTION BY TOWN STAFF OF ALL IN-PLACE SEEC MEASURES PRIOR TO ANY SITE WORK OR SURFACE DISTURBANCE.

SOIL EROSION & SEDIMENT CONTROL NARRATIVE

- 4-1) THIS PARCEL IS CURRENTLY UNDEVELOPED & 100% WOODED. NO EXISTING BUILDINGS OR OTHER STRUCTURES, PAVEMENT OR UTILITIES EXISTING WITH THE LOT LIMITS.
- 4-2) THE PARCEL IS ADJACENT TO DEVELOPED I-FAMILY USES IN WRP-160 ZONE ALONG ADJACENT NORTH & SOUTH BOUNDARIES & ACROSS THE STREET.
- 4-3) SOIL TYPES ON THIS SITE ARE CLASSIFIED BY THE USDA/NRCS AS FOLLOWS:  
62C - Canton & Charlton Fine Sandy Loams; 3%-15% Slopes; Extreme Stony
- 4-4) THE ESTIMATED CONSTRUCTION DATES ARE:  
- COMMENCEMENT: MAY 2022  
- COMPLETION : MAY 2023 (EST DURATION = 12 MONTHS).
- 4-5) THIS PROJECT IS PROPOSED TO BE CONSTRUCTED IN (1) PHASE.
- 4-6) THE CONTRACTOR SHALL PROVIDE ADEQUATE FACILITIES AND EQUIPMENT FOR DUST CONTROL DURING DEMOLITION PHASES THROUGH CONSTRUCTION PHASES. DUST CONTROL SHALL BE A PRIMARY CONCERN AND SHALL BE ABATED WITH ADEQUATE WATER TRUCKS AND REGULAR WATER SPRAYING AS NEEDED.
- 4-7) THE AREAS OF MAJOR IMPORTANCE FOR SEDIMENTATION & EROSION CONTROL FOR THIS PROJECT INCLUDE, BUT NOT LIMITED TO THE FOLLOWING:  
- ALL AREAS IMMEDIATELY DOWNSLOPE OF EXCAVATIONS OR ANY EARTH CUTS.  
- ALL ADJACENT PROPERTIES;  
- EXISTING WETLAND AREA ALONG BOTH SIDES OF DRIVEWAY CROSSING  
- ALL ADJACENT ROAD GUTTERS AND ROW'S.
- 4-8) THE CONTRACTOR SHALL PROVIDE ADEQUATE FACILITIES & EQUIPMENT FOR EXCAVATION DE-WATERING AS REQUIRED. ALL DE-WATERING METHODS TO BE IMPLEMENTED SHALL BE REVIEWED AND APPROVED BY TOWN STAFF PRIOR TO IMPLEMENTATION. THE CONTRACTOR SHALL NOT DISCHARGE ANY TREATED SEDIMENT LADEN GROUNDWATER TO THE WETLAND AREAS, ADJACENT PROPERTIES OR PUBLIC STREET.

DRIVEWAY PROFILE

PREPARED FOR  
**LAWRENCE DARLING**  
0 RIDGE HILL ROAD - OAKDALE  
MAP-BLOCK-LOT: 006-015-000  
**MONTVILLE, CONNECTICUT**

SCALE: AS NOTED DATE: MAY 2022 JOB NO: C1089 SHEET 3 OF 3

PREPARED BY:  
**DGT Associates**  
Surveying &  
Engineering  
Preston, CT • Boston • Worcester  
Framingham  
148 CT-2, Preston, CT 06365  
860-899-1999 www.DGTassociates.com

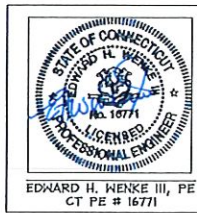

**EDWARD H. WENKE III, PE**  
CIVIL - STRUCTURAL ENGINEER  
Licensed in : Connecticut, New York, Rhode Island, Maine  
Massachusetts, Maryland, Pennsylvania, Wisconsin, California  
P.O. Box 544 MUKWONAGO, WI 53149  
Ph: 860.460.1606 Email: ewenke@comcast.net

REV-C: 08/10/22  
- REV ELEV'S END OF DRIVEWAY  
REV-B: 06/19/22 - ADDED:  
- UNCAS HEALTH RWV COMMENTS;  
- WETLANDS PERMIT COND OF APPROVAL  
- REV BARN BLDG & DRIVEWAY TO HOUSE  
**ISSUE FOR CONSTRUCTION**