

820 WEST STREET, AMHERST, MA 01002
PHONE: 413-548-8000 FAX 413-549-4000
EMAIL: INFO@NEWP.COM WEB ADDRESS: WWW.NEWP.COM

Botanical Name	Common Name	Indicator
<i>Elymus riparius</i>	Riverbank Wild Rye	FACW
<i>Schizachyrium scoparium</i>	Little Bluestem	FACU
<i>Festuca rubra</i>	Red Fescue	FACU
<i>Andropogon gerardii</i>	Big Bluestem	FAC
<i>Panicum virgatum</i>	Switch Grass	FAC
<i>Vernonia noveboracensis</i>	New York Ironweed	FACW+
<i>Agrostis perennans</i>	Upland Bentgrass	FACU
<i>Bidens frondosa</i>	Beggar Ticks	FACW
<i>Eupatorium maculatum</i> (<i>Eutrochium maculatum</i>)	Spotted Joe Pye Weed	OBL
<i>Eupatorium perfoliatum</i>	Boneset	FACW
<i>Aster novae-angliae</i> (<i>Symphotrichum novae-angliae</i>)	New England Aster	FACW-
<i>Scirpus cyperinus</i>	Wool Grass	FACW
<i>Juncus effusus</i>	Soft Rush	FACW+

The New England Erosion Control/Restoration Mix for Detention Basins and Moist Sites contains a selection of native grasses and wildflowers designed to colonize generally moist, recently disturbed sites where quick growth of vegetation is desired to stabilize the soil surface. It is an appropriate seed mix for ecologically sensitive restorations that require stabilization as well as long-term establishment of native vegetation. This mix is particularly appropriate for detention basins that do not hold standing water. Many of the plants in this mix can tolerate infrequent inundation, but not constant flooding. The mix may be applied by hand, by mechanical spreader, or by hydro-seeder. After sowing, lightly rake, roll or cultipack to insure good seed-to-soil contact. Best results are obtained with a Spring or late Summer seeding. Late Fall and Winter dormant seedling requires an increase in the application rate. A light mulching of clean, weed-free straw is recommended.

820 WEST STREET, AMHERST, MA 01002
PHONE: 413-548-8000 FAX 413-549-4000
EMAIL: INFO@NEWP.COM WEB ADDRESS: WWW.NEWP.COM

Botanical Name	Common Name	Indicator
<i>Carex vulpinoidea</i>	Fox Sedge	OBL
<i>Carex scoparia</i>	Blunt Broom Sedge	FACW
<i>Carex lurida</i>	Lurid Sedge	OBL
<i>Carex lupulina</i>	Hop Sedge	OBL
<i>Poa palustris</i>	Fowl Bluegrass	FACW
<i>Bidens frondosa</i>	Beggar Ticks	FACW
<i>Scirpus atrovirens</i>	Green Bulrush	OBL
<i>Asclepias incarnata</i>	Swamp Milkweed	OBL
<i>Carex crinita</i>	Fringed Sedge	OBL
<i>Vernonia noveboracensis</i>	New York Ironweed	FACW+
<i>Juncus effusus</i>	Soft Rush	FACW+
<i>Aster lateriflorus</i> (<i>Symphotrichum lateriflorum</i>)	Starved/Calico Aster	FACW
<i>Iris versicolor</i>	Blue Flag	OBL
<i>Glyceria grandis</i>	American Mannagrass	OBL
<i>Mimulus ringens</i>	Square Stemmed Monkey Flower	OBL
<i>Eupatorium maculatum</i> (<i>Eutrochium maculatum</i>)	Spotted Joe Pye Weed	OBL

The New England Wetmix (Wetland Seed Mix) contains a wide variety of native seeds that are suitable for most wetland restoration sites. The mix is not permanently flooded. All species are best suited to moist ground as found in most wet meadows, scrub shrub, or forested wetland restoration areas. The mix is well suited for detention basin borders and the bottom of detention basins not generally under standing water. The seeds will not germinate under inundated conditions. If planted during the fall months the seed mix will germinate the following spring. During the first season of growth several species will produce seeds while other species will produce seeds after the second growing season. Not all species will grow in all wetland situations. This mix is comprised of the wetland species most likely to grow in created/restored wetlands and should produce more than 75% ground cover in two full growing seasons.

The wetland seeds in this mix can be sown by hand, with a hand-held spreader, or hydro-seeded on large or hard to reach sites. Lightly rake to insure good seed-to-soil contact. Seeding can take place on frozen soil, as the freezing and thawing weather of late fall and late winter will work the seed into the soil. If spring conditions are drier than usual watering may be required. If sowing during the summer months supplemental watering will likely be required until germination. A light mulch of clean, weed free straw is recommended.

820 WEST STREET, AMHERST, MA 01002
PHONE: 413-548-8000 FAX 413-549-4000
EMAIL: INFO@NEWP.COM WEB ADDRESS: WWW.NEWP.COM

Botanical Name	Common Name	Indicator
<i>Elymus virginicus</i>	Virginia Wild Rye	FACW-
<i>Schizachyrium scoparium</i>	Little Bluestem	FACU
<i>Andropogon gerardii</i>	Big Bluestem	FAC
<i>Festuca rubra</i>	Red Fescue	FACU
<i>Sorghastrum nutans</i>	Indian Grass	UPL
<i>Panicum virgatum</i>	Switch Grass	FAC
<i>Chamaecrista fasciculata</i>	Partridge Pea	FACU
<i>Desmodium canadense</i>	Showy Tick Trefoil	FAC
<i>Asclepias tuberosa</i>	Butterfly Milkweed	NI
<i>Bidens frondosa</i>	Beggar Ticks	FACW
<i>Eupatorium purpureum (Eutrochium maculatum)</i>	Purple Joe Pye Weed	FAC
<i>Rudbeckia hirta</i>	Black Eyed Susan	FACU-
<i>Aster pilosus (Symphyotrichum pilosum)</i>	Heath (or Hairy) Aster	UPL
<i>Solidago juncea</i>	Early Goldenrod	
PRICE PER LB. \$39.50 MIN. QUANTITY 2 LBS.	TOTAL: \$79.00	APPLY: 25 LBS/ACRE :175

The New England Conservation/Wildlife Mix provides a permanent cover of grasses, wildflowers, and legumes

For both good erosion control and wildlife habitat value. The mix is designed to be a no maintenance seeding, and is appropriate for cut and fill slopes, detention basin side slopes, and disturbed areas adjacent to commercial and residential projects.

RATIO Wall

RWL1RWL2 LED WALLPACK

FEATURES

- Low profile LED wall luminaire with a variety of EIS distributors for lighting applications such as retail, commercial and industrial building mount
- Featuring Strike and Micro Strike OPTICS which maximizes target zone illumination with minimal losses at the house-side, reducing light trespass issues
- Visual comfort standard
- Control options including photo control, occupancy sensing, NIK Distributed Intelligence™, LightGRID+ and 7-Pin with networked controls
- Battery Backup options available for emergency code compliance
- Quick-mount adapter allows easy installation/maintenance
- 347V and 480V versions for industrial applications and Canada

CONTROL TECHNOLOGY

SPECIFICATIONS

CONSTRUCTION

- Die-cast housing with hidden vertical heat fins that are optimal for heat dissipation while keeping a clean smooth outer surface
- Corrosion resistant, die-cast aluminum housing with powder coat paint finish
- Powder paint finish provides durability in all environments. Tested to meet 1000 hour salt spray rating

OPTICS

- Entire optical aperture illuminates to create a clean smooth outer surface
- Low glare appearance without sacrificing optical performance

40 or 160 mired LEDs

- 4000K, 4000K or 5000K 70 CRI/80 CRI CCT
- Zero ULIGHT distributions
- LED optics provide IE5 type III, II, and IV distributions. Type I only available in RWL2 configurations

INSTALLATION

- Quick-mount adapter provides easy installation to wall or to recessed junction boxes (see installation section box)
- Designed for direct job mount
- Integral back box contains T12 conduit stubs
- Integral back box standard with Dual Driver, Dual Power Feed, NIK LightGRID+ and battery options (battery versions for RWL1 only)

ELECTRICAL

- 120V/277V universal voltage 50/60Hz 0.10V dimming driver
- 347V and 480V dimming driver option for all wattages above 35W
- Ambient operating temperature -40°C to 40°C
- Driver RoHS and IP66

DATE	LOCATION
TYPE	PROJECT
CATALOG #	

MICROSTRIKE | STRIKE

SERVICE PROGRAM

ELECTRICAL (CONTINUED)

- 10KV Surge Protector optional
- Drivers have greater than 50 power factor and less than 40% Total Harmonic Distortion
- Dual Driver option provides 2 drivers within luminaire but only one set of leads exiting the luminaire, where Dual Power Feed provides two drivers which can be wired independently as two sets of leads or connected to the luminaire. Both options can not be included in one same fixture.
- Dimming drivers are standard and dimming levels are extended out of the luminaire unless control options require connection to the luminaire. Must specify if wiring leads are to be greater than 6" standard

CONTROLS

- Photo control, occupancy sensor and wireless available for complete on/off and dimming control
- Button photocontrol is suitable for 120-277V operation

- 7-pin ANSI C136.41 2013 photocontrol receptacle option available for twist lock photocontrols or wireless control modules (control accessories sold separately)
- NIK Distributed Intelligence™ available with in fixture wireless control module, features dimming and occupancy sensor
- Integral Battery Backup provides emergency lighting for the required 90 minute path of egress
- Battery Backup suitable for operating temperatures -25°C to 40°C. RWL1 battery is 12.5W RWL2 battery is 18W

	Weight
RWL1	85 lbs / 295 kg
RWL2	185 lbs / 748 kg

CONTROLS (CONTINUED)

- Dual Driver and Dual Power Feed options creates product configuration with 2 internal drivers for code compliance
- Please consult brand or sales representative when combining control and electrical options as some combinations may not operate as anticipated depending on your application
- LightGRID+ available with in fixture wireless control module, features dimming and occupancy sensor. Also available in 7-pin configuration

CERTIFICATIONS

- Certified to UL 1598 and CSA 22.2#250-24 for wet locations
- IP65 rated housing
- DLC® (DesignLights Consortium Qualified), with some Premium Q-qualified configurations. Not all product variations listed in this document are DLC® qualified. Refer to <http://www.designlights.org> for the most up-to-date list.
- Emergency battery backup options are California Energy Commission (CEC) Title 20 Compliant
- Meets IAC requirements using 3K CCT configuration at 40 degrees or tilt

WARRANTY

- 5 year limited warranty

Current®

currentlighting.com/beacon

© 2024 HLS Illuminaria, Inc. All rights reserved. Information and specifications subject to change without notice. All values are design or typical values unless otherwise stated. Secondary conditions.

Page 1 of 10
Doc 172722-04
Ratio_Wall_Spec_Sheet_Rev_007

RATIO Series

AREA/SITE LIGHTER

FEATURES

- Full profile LED area/site luminaire with a variety of IES distributions for lighting applications such as retail, commercial and campus parking lots
- Featuring Micro Strike Optics which maximizes target zone illumination with minimal losses at the house-side, reducing light trespass issues
- Visual comfort standard
- Die-cast housing with hidden vertical heat fins that are optimal for heat dissipation while keeping a clean smooth outer surface
- 3G rated for high vibration applications including bridges and overpasses
- Control options including photo control, occupancy sensing, NX Distributed Intelligence® and 7-Pin with networked controls
- Best in class surge protection available

CONTROL TECHNOLOGY

SERVICE PROGRAMS

SPECIFICATIONS

CONSTRUCTION

- Rectilinear form mimics the traditional boxcan form factor keeping a similar but unique style and appearance, ideal for retrofit applications
- Die-cast housing with hidden vertical heat fins that are optimal for heat dissipation while keeping a clean smooth outer surface
- Corrosion resistant, die-cast aluminum housing with powder coat paint finish

OPTICS

- Entire optical aperture illuminates to create a larger luminous surface area resulting in a low glare appearance without sacrificing optical performance
- 90, 150, 320 or 480 midpower LEDs
- 3000K, 4000K or 5000K (70 CRI) CCT
- Zero spillout at 0 degrees of tilt
- Field adjustable optics

INSTALLATION

- Standard square arm mount, compatible with B3 drill pattern
- Optional universal mounting block for ease of installation during retrofit applications. Available as an option or accessory for square and round poles
- Knock-in arm filter option available for 2-3/8" OD NEMA. Max tilt of 60 degrees with 4 degree adjustable increments. (Restrictions apply for 7-pin options)

ELECTRICAL

- Universal 200/277 VAC or 347-480 VAC input voltage; 50/60 Hz
- Ambient operating temperature: -40°C to 40°C
- Drivers have greater than 90% power factor and less than 20% THD
- LED drivers have output power over-voltage, over-current protection and short circuit protection with auto recovery
- Field replaceable surge protection device provides 20kA protection meeting ANSI/IEEE C62.41-2 Category C2 High and Surge Location Category C2; Automatically takes future off-line for protection when device is compromised

CONTROLS

- Photo control, occupancy sensor and wireless available for complete on/off and dimming control
- 7-pin ANSI C136.4-2013 photocentric receptacle option available for twist lock photocentrics or wireless control modules (control accessories sold separately)
- 0-10 V Dimming Drivers are standard and dimming leads are extended out of the luminaire unless control options require connection to the dimming leads. Must specify if wiring leads are to be greater than the 6" standard
- NX Distributed Intelligence® available with in-fixture wireless control module, features dimming and occupancy sensor

CERTIFICATIONS

- DLC (Designlight Consortium Qualified), with some Premium Qualification certifications. Not all product variations on this page are DLC Qualified. Refer to www.designlights.org for the most up-to-date list.
- Listed to UL1598 and CSA C22.2#250-04 for use locations and 40°C ambient temperatures
- 3G rated for ANSI C136.31 high vibration applications
- Fixture is IP66 rated
- Meets ICA recommendations using 3K CCT configuration at 0 degrees of tilt
- This product meets federal procurement law requirements under the Bay Area Anti-FSAB §2.225-9 and Trade Agreements Act (FAR §2.225-10). See Bay Area Anti-FSAB §2.225-9 at www.currentlighting.com/pdfs/bayarea/bsab225.pdf (see page 3)

WARRANTY

- 5 year limited warranty
- See [Link](#) Standard Warranty for additional information

	Weight	EPA at 0°
RAR1	13.6 lbs / 6.1 kg	45ft ² / 13m ²
RAR2	24 lbs / 10.9 kg	55ft ² / 17m ²

Current®

currentlighting.com/beacon

© 2023 HCL Solutions, Inc. All rights reserved. Information and specifications subject to change without notice. All values are typical values or target values when tested under laboratory conditions.

Page 1 of 6

Rev: 07/22/2024

IEA, Ratio, RAR1, 2, 3, 4, 5, 6, 7, 8, 9, 10, 11, 12, 13, 14, 15, 16, 17, 18, 19, 20, 21, 22, 23, 24, 25, 26, 27, 28, 29, 30, 31, 32, 33, 34, 35, 36, 37, 38, 39, 40, 41, 42, 43, 44, 45, 46, 47, 48, 49, 50, 51, 52, 53, 54, 55, 56, 57, 58, 59, 60, 61, 62, 63, 64, 65, 66, 67, 68, 69, 70, 71, 72, 73, 74, 75, 76, 77, 78, 79, 80, 81, 82, 83, 84, 85, 86, 87, 88, 89, 90, 91, 92, 93, 94, 95, 96, 97, 98, 99, 100

TARGETT

MR. BO

Radial Emission LED Bollard

Flat Top
version shown

Angled Top
version shown

Dome Top
version shown

Dark Sky
compliant

RoHS
compliant

IP66
rating

UL
listing

CONCEPT

Radial emission LED bollard specifically designed to light large open spaces.

FIXTURE MECHANICAL CHARACTERISTICS

Housing	Ø 6.3" Dia.
Materials	Powder coated anodized die-cast aluminum optical head with extruded body. Marine Grade cataphoresis® available as optional.
Finish	Textured finish.
	<input checked="" type="checkbox"/> Ferrite Dark Grey <input checked="" type="checkbox"/> Black <input type="checkbox"/> White <input type="checkbox"/> Bronze <input type="checkbox"/> Sandstone Grey <input type="checkbox"/> Heritage Brown

Power Factory shipped with DSMAT IP68 quick disconnect or feature and mating 48-500W B-6 cable with purple and grey wires for 0-10V.

Functionality Available in three different heights - 16in, 32in and 40in nominal for flat head or 17in, 33in and 41in nominal for domed and angled heads. 36in, 36in stainless steel base and stainless steel lift the screws. Optional integral 90 minute emergency battery back at 8W output (14W 57W / 11W 42% / 27W 30%); ambient temperature not to drop below 0°C or exceed 50°C. Optional integral smart PIR motion sensor, factory preset to 100% ON fade to 25% output after 30 minutes if no motion is detected, control factory for custom settings.

BUG BUG-01 Dark Sky Compliant

Weight 16" - 6.5lbs / 32" - 10lbs / 40" - 13lbs
17" - 7.5lbs / 33" - 11lbs / 41" - 14lbs
(includes feature head and post only)

Protection IP66

Resistance IK10

CERTIFICATIONS

cULus Wet Location Listed E486267
Tested in accordance with LM-79-08.
Compliant for California Installations.
IEC 62471
RoHS CE EU 2015/853

WARRANTY

5 year limited warranty.

ELECTRICAL CHARACTERISTICS

Driver Integral 41 smart driver (Non-Dimmable / 0-10V / Reverse Phase / Forward Phase)

Wattage 27W (360°) / 15W (180° / 90°/90°) / 14W (90°)

Voltage Universal Voltage 120-277V AC 50/60Hz

SOURCE

LED Chip on Board

TM30	CCT (Nominal)	CRI	R _f	R _g	SDCM
2700K	80	82	96	96	2
3000K	80	83	96	2	
3500K	80	82	95	2	
4000K	80	82	95	2	

(R_f/R_g available upon request)

OPTIC

Internal high reflective anodized aluminum reflector with transparent polycarbonate lens positioned horizontally under optical head with external black anti-glare control.

Beam	360°	180°	90°	90°/90°
------	------	------	-----	---------

Delivered Lumens	2700K	3000K	3500K	4000K
	1167lm	1271lm	1248lm	1306lm
	873lm	901lm	933lm	933lm
	292lm	306lm	313lm	313lm
	598lm	623lm	639lm	639lm

For 3500K lumens value multiplier of 102 from 3000K.

Efficiency 52lm/W max. Refer to photometric graphs for specific values.

Lifetime L52/B10 30000hrs at max TA +25°C
L50/B10 50000hrs at max TA +25°C

Photobiological Classification Low risk: safety RG3

SUSTAINABILITY

Luminaire designed for disposability recycling at end-of-life. Replaceable LED light source and control gear by a Targett technician.

Targett USA 3F Filippi | Targett Group Company

750-A 10th St, Costa Mesa, CA 92627

(714) 513-1891

targettusa.com

rev. 07/2024

pg. 1 of 6

WALL MOUNTED LIGHT (WL1A)
SCALE: NTS

4 STREET LIGHT (SL1, SL2, SL3)
SCALE: NTS

2 BOLLARD LIGHT (BL1)
SCALE: NTS



LTR-6RD
LITEISTRY 6" ROUND DOWNLIGHT

FEATURES

- 6" architectural LED downlight delivering 600 – 9000 lm
- Five beam distributions from 0.3 to 11 Spacing Criteria
- Quiet reflector appearance with superior 50:1 optical cutoff
- 2700K – 5000K, 80+ and 90+ CRI options
- Available for New Construction (non-IC), IC and Chicago Plenum applications
- Variety of dimming protocol options including 0-10V, DALI, DMX, and Lutron EcoSystem
- NX Lighting Controls wired and wireless controls capability available



CONTROL TECHNOLOGY



SPECIFICATIONS

CONSTRUCTION

- Standard Non-IC, Chicago Plenum and IC options
- Painted black durable steel platform with pre-installed bar hangers
- Pre-wired junction box with snap-on covers for easy access
- Snap-in connection from driver compartment allows easy installation
- Light Engine connections use plenum rated (CMP) cable

OPTICS

- Visually pleasing 50° cutoff to source and source image
- The light distribution is free of distracting bright spots or pixelation and the perimeter has a smooth transition
- Optical grade silicone lens integral to light engine
- High purity spun aluminum reflector, self-flanged
- Flush mount flange option with mudring ring available
- Large selection of anodized finishes and colors
- Painted cones and flange options available

ELECTRICAL

- Chip-on-board LED with 2 SDCM
- Multiple CCTs, 80+ or 90+ CRI
- Long LED life: L80 at >55,000 hours (TM-21)
- Universal voltage: 120V-277V driver, 347V optional
- UL Class 2, inherent short circuit and overvoltage protection

ELECTRICAL (CONTINUED)

- Flicker free 0-10V dimming with 1% or <1% performance
- DALI, DMX, and Lutron EcoSystem options
- NX Lighting Controls provides options for standalone and networked functionality with wired or wireless connectivity for NX system deployments
- Lutron Athena control options also available
- Integral and remote controller and battery pack options available
- Refer to additional spec sheets for information on: SpeechSync™, Tunable White or Dim-to-Warm or solutions

INSTALLATION

- Accommodates ceiling thickness up to 2" (SL, ML, HL, up to 125° VL, XL) (See DIMENSIONS section for details)
- Universal adjustable mounting brackets also accept 1/2" EMT conduit or 1/2" or 1/2" listing channel (by others) or Prescolite accessory bar hangers (B04 or B06)
- Light Engine/Driver fully serviceable from above or below the ceiling

CERTIFICATIONS

- cULusA certified to UL 1698
- For 270V, Marked spacing required 36" fixture center to center, 36" fixture center to building member; 0.5" above fixture
- Suitable for wet locations, covered ceiling, EM/EMR: Suitable for damp locations

DATE: _____ LOCATION: _____
TYPE: _____ PROJECT: _____
CATALOG #: _____

LITEISTRY



SERVICE PROGRAMS

STÖCK QS10

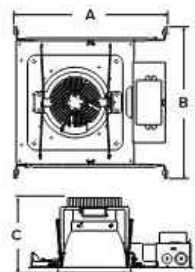

Typical Dimensions and Weights				
Lumen Package	W Length Inches (mm)	H Width Inches (mm)	H Height Inches (mm)	Weight lbs (kg)
05L - 15L	14.56 (370)	14.36 (365)	5.3 (135)	7.8 (3.5)
20L - 30L	14.56 (370)	14.36 (365)	6.68 (170)	8.2 (3.7)
35L - 45L	14.56 (370)	14.36 (365)	7.86 (200)	8.9 (4)
50L - 60L	14.56 (370)	14.36 (365)	9.04 (230)	9.9 (4.5)
70L - 90L	14.56 (370)	15.56 (395)	11.56 (295)	12.1 (5.5)

See DIMENSIONS section for complete details

CERTIFICATIONS (CONTINUED)

- EMI/EMR: Certified under UL 924 standard for emergency lighting and power equipment
- EMI/EMR: Emergency battery packs are California Energy Commission (CES) Title 20 Compliant
- When used with CE Bezel Trim Accessories: IP66/ IP69K rating, also meets IK10 per IEC 60068-2-75 impact testing
- Approved for B (4 in/4 out) No. 12AWG conductors rated for 90°C through wiring
- ENERGY STAR® certified models available. For list and additional information, visit www.energystar.gov
- For BAA Option: This product meets federal procurement law requirements under the Buy American Act (FAR 52.225-9) [See Buy American Solutions](http://www.buyamericasolutions.com)
- For TAA Option: Product configurations meet federal procurement law requirements under the Trade Agreements Act (FAR 52.225-11) [See Buy American Solutions](http://www.buyamericasolutions.com)

WARRANTY

- 5 year warranty

KEY DATA	
Lumen Range	600-9000
Wattage Range	8-99
Efficacy Range (LPW)	94-104*
Reported Life (Hours)	L80 / >55,000
Input Current (mA)	65-825 (120V)

*Based on Specular, 35K, 80 CRI



currentlighting.com/prescolite
© 2024 HLI Solutions, Inc. All rights reserved. Information and specifications subject to change without notice. All values are design or typical values unless otherwise noted under laboratory conditions.

Page 1 of 10
Rev: 11/05/23
LTR-6RD_R08



LNC2
SMALL LED LITEPAK

FEATURES

- 60% more lumens and increased performance than smaller LNC models
- 3000K, 4000K and 5000K as well as Phosphor Converted Amber
- Type II, III and IV distributions available for a variety of application needs
- Quick-mount adapter allows easy installation/maintenance
- 347V and 480V versions for industrial applications and Canada
- 347V and 480V versions for industrial applications and Canada
- Full cut-off, neighbor friendly
- Optional photocell for additional energy savings



CONTROL TECHNOLOGY



SPECIFICATIONS

CONSTRUCTION

- Rugged die-cast aluminum housing protects components and provides an architectural appearance
- Casting thermally conducts LED heat to optimize performance and long life
- Powder paint finish provides durability in outdoor environments. Tested to meet 1000 hour salt spray rating
- Construction tested to ASTM B117 for 1000 hours of salt spray

OPTICS

- Zero uplight distributions using individual acrylic Micro Strike Optics
- LED optics provide IES type II and IV distributions. Optional (CS) acrylic diffuser available for reduced glare
- L96 at 60,000hrs (Projected per IESNA TM-21-11), see table on page 3 for all values

INSTALLATION

- Quick-mount adapter provides easy installation to wall or to recessed junction boxes (4" square junction box)
- Designed for direct, down mount
- Optional 1/2" conduit hubs available (standard for control options and battery versions)

DATE: _____ LOCATION: _____
TYPE: _____ PROJECT: _____
CATALOG #: _____



SERVICE PROGRAMS

QS10

ELECTRICAL

- 120V-277V universal voltage 50/60Hz 0-10V dimming drivers
- 347V and 480V dimmable driver option available in 25W and 35W configurations
- Minimum operating temperature is -40°C/-40°F
- Drivers have greater than 90 power factor and less than 20% Total Harmonic Distortion
- Driver RoHS and IP66
- 10kA surge protector available as an option
- 3000K CCT nominal, 4000K CCT nominal, 5000K CCT nominal (70 CRI)

CONTROLS

- Universal button photocell for use with 100-277V configurations
- Occupancy sensor options available for complete on/off and dimming control
- NX Lighting Controls™ available that feature dimming and occupancy sensor
- Integral Battery Backup provides emergency lighting for the required 90 minute path of egress. Uses 15 watts of power for about 2000 lumens
- Dual Driver option provides 2 drivers within luminaire but only one set of leads exiting the luminaire, where Dual Power Feed provides two drivers which can be wired independently as two sets of leads are extended from the luminaire. Both options can not be included in one fixture.

CERTIFICATIONS

- Listed to UL 1698 and CSA C22.2 #250.0-24 for wet locations
- DLC® (DesignLights Consortium Qualified), with some Premium Qualified configurations. Not all product variations on this page are DLC Qualified. Refer to <http://www.designlights.org/> for the most up-to-date list.
- Fixture is IP65 rated

WARRANTY

- 5 year warranty

KEY DATA	
Lumen Range	1000-5000
Wattage Range	10-45
Efficacy Range (LPW)	108-124
Weights lbs. (kg)	9.8 (24.5)



currentlighting.com/exo
© 2024 HLI Solutions, Inc. All rights reserved. Information and specifications subject to change without notice. All values are design or typical values unless otherwise noted under laboratory conditions.

Page 1 of 6
Rev: 05/07/24
EXO_LNC2_spec_R07

2 BUILDING MOUNTED LIGHT (WL3)
SCALE: NTS

1 WALL MOUNTED LIGHT (WL1C)
SCALE: NTS

MDLA

MICHAEL D'ANGELO
LANDSCAPE ARCHITECTURE LLC

119 GRISWOLD STREET
SUITE 209
GIASTONBURY, CT 06033
T. 203.592.4788
www.m-d-a.com

HORIZON VIEW
MONTVILLE, CT

STAMP



REV. NO.	DATE	DESCRIPTION
	9/25/24	INLAND WETLANDS SUBMISSION

LANDSCAPE
DETAILS
PLAN

DRAWN:
MR, CB
CHECKED:
MR
SCALE:
AS NOTED
DATE:
09/25/24

L302

SHEET 6 OF 6

NOT FOR CONSTRUCTION

plot date: 9/24/2024

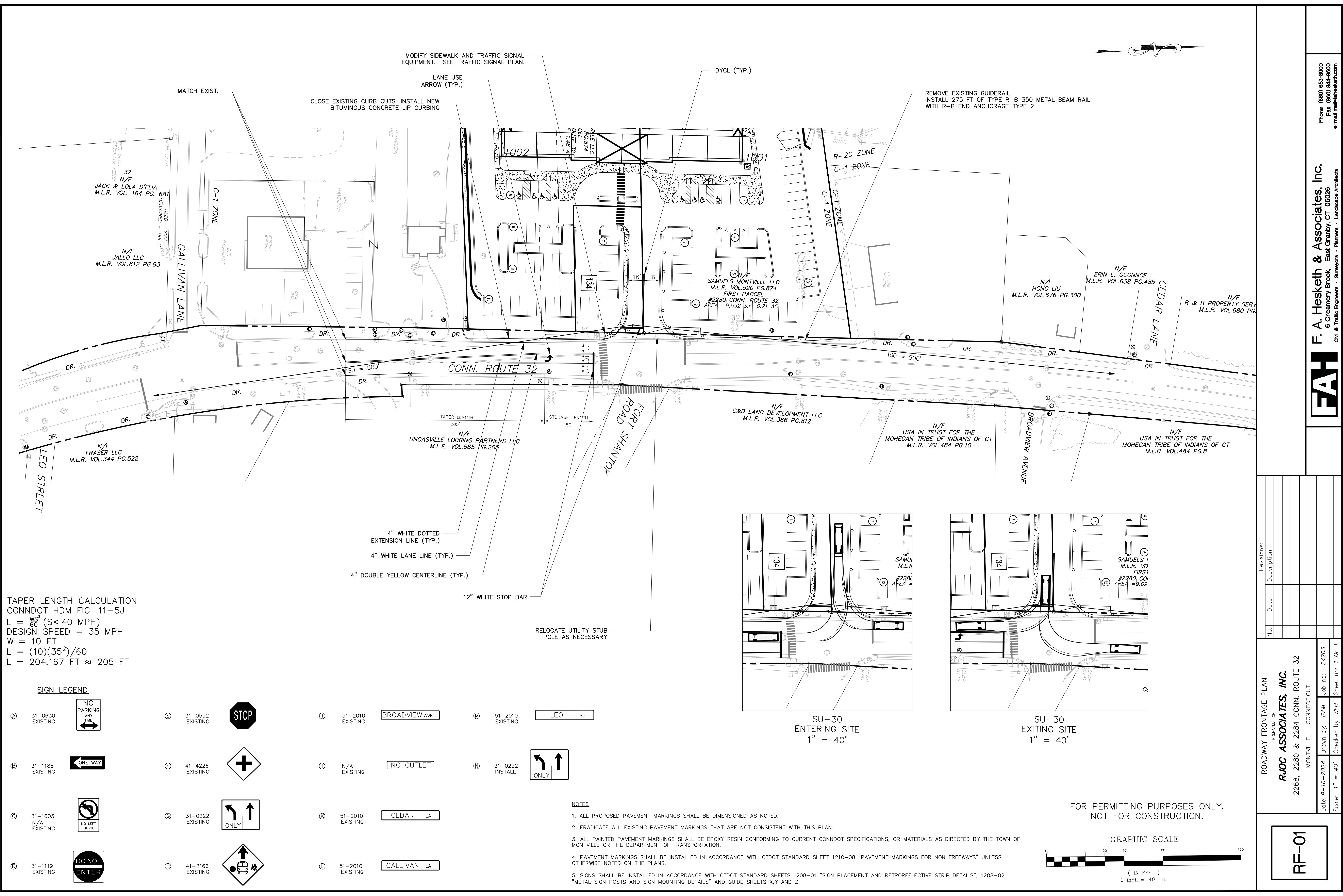

TAPER LENGTH CALCULATION
CONNDOT HDM FIG. 11-5J
 $L = \frac{WS^2}{60}$ (S < 40 MPH)
DESIGN SPEED = 35 MPH
W = 10 FT
 $L = \frac{(10)(35^2)}{60}$
L = 204.167 FT \approx 205 FT

SIGN LEGEND

Ⓐ 31-0630 EXISTING

Ⓒ 31-1188 EXISTING

Ⓓ 31-1603 N/A EXISTING

Ⓔ 31-1119 EXISTING

Ⓔ 31-0552 EXISTING

Ⓕ 41-4226 EXISTING

Ⓖ 31-0222 EXISTING

Ⓗ 41-2166 EXISTING

Ⓜ 51-2010 EXISTING

BROADVIEW AVE

Ⓜ 51-2010 EXISTING

LEO ST

Ⓜ 51-2010 EXISTING

NO OUTLET

Ⓜ 51-2010 EXISTING

CEDAR LA

Ⓜ 51-2010 EXISTING

GALLIVAN LA

Ⓜ 51-2010 EXISTING

LEO ST

Ⓜ 51-2010 EXISTING

NO OUTLET

Ⓜ 51-2010 EXISTING

CEDAR LA

Ⓜ 51-2010 EXISTING

GALLIVAN LA

- NOTES**
- ALL PROPOSED PAVEMENT MARKINGS SHALL BE DIMENSIONED AS NOTED.
 - ERADICATE ALL EXISTING PAVEMENT MARKINGS THAT ARE NOT CONSISTENT WITH THIS PLAN.
 - ALL PAINTED PAVEMENT MARKINGS SHALL BE EPOXY RESIN CONFORMING TO CURRENT CONNDOT SPECIFICATIONS, OR MATERIALS AS DIRECTED BY THE TOWN OF MONTVILLE OR THE DEPARTMENT OF TRANSPORTATION.
 - PAVEMENT MARKINGS SHALL BE INSTALLED IN ACCORDANCE WITH CTDOT STANDARD SHEET 1210-08 "PAVEMENT MARKINGS FOR NON FREEWAYS" UNLESS OTHERWISE NOTED ON THE PLANS.
 - SIGNS SHALL BE INSTALLED IN ACCORDANCE WITH CTDOT STANDARD SHEETS 1208-01 "SIGN PLACEMENT AND RETROREFLECTIVE STRIP DETAILS", 1208-02 "METAL SIGN POSTS AND SIGN MOUNTING DETAILS" AND GUIDE SHEETS X,Y AND Z.

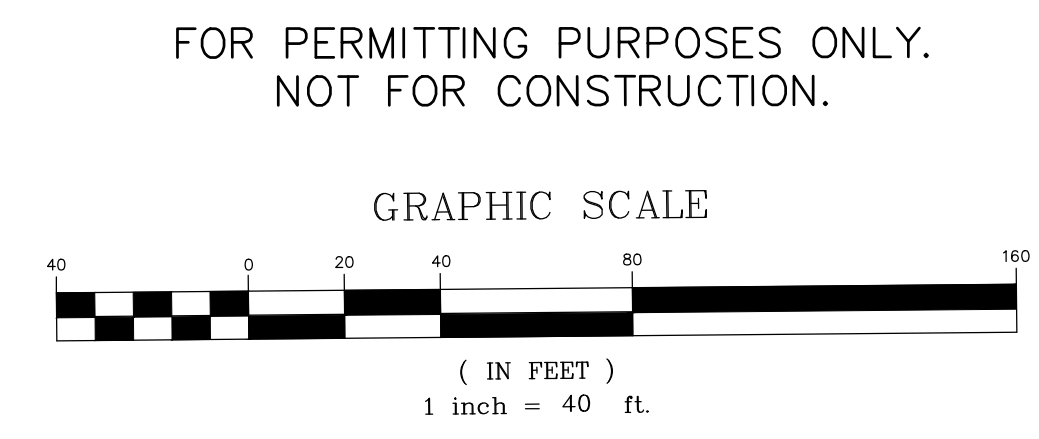

ROADWAY FRONTAGE PLAN
PREPARED FOR
RJC ASSOCIATES, INC.
2268, 2280 & 2284 CONN. ROUTE 32
MONTVILLE, CONNECTICUT

Revisions:

No.	Date	Description

RF-01

F. A. Hesketh & Associates, Inc.
6 Creamery Brook, East Granby, CT 06026
Civil & Traffic Engineers • Planners • Landscape Architects

Phone (860) 883-8000
Fax (860) 844-8600
e-mail: fah@fahinc.com

