

**PROPERTY LOCATION**  
176 MEETING HOUSE LANE (CAMP OAKDALE)  
MONTVILLE, CONNECTICUT 06382  
046 / 069 / 000  
UNIQUE ID: M0221200

**PROPERTY OWNER & APPLICANT**  
TOWN OF MONTVILLE  
310 NORWICH NEW LONDON TURNPIKE  
UNCASVILLE, CONNECTICUT 06382

**ZONE**  
OPEN SPACE (OS)

ZONING COMPLIANCE TABLE		
Zone: Open Space District (OS)		
ITEM	REQUIRED	PROPOSED
LOT AREA	4 ACRES	±79.81 ACRES
FRONTAGE	150 FT.	±2,600 FT.
FRONT YARD SETBACK	50 FT.	±430 FT.
SIDE YARD SETBACK	30 FT.	±455 FT.
REAR YARD SETBACK	50 FT.	±1,970 FT.
BUILDING HEIGHT	35 FT.	±30 FT.

APPROVED BY THE MONTVILLE PLANNING AND ZONING COMMISSION

CHAIRMAN, VICE CHAIRMAN, OR SECRETARY OF THE COMMISSION      DATE

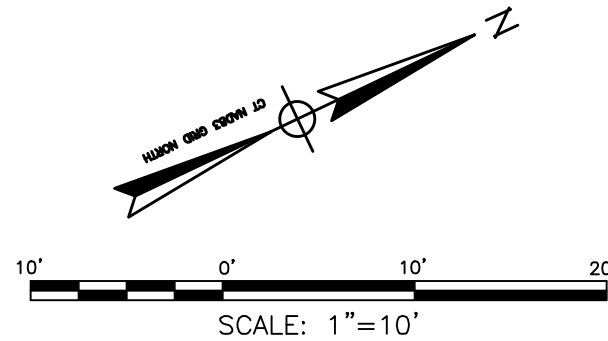

CLA Engineers, Inc.

CIVIL • STRUCTURAL • SURVEYING

317 Main Street Norwich, CT 06360  
(860) 886-1966 Fax (860) 886-9165

Project No.  
CLA-6314S

Proj. Engineer  
K.J.H.

Date:  
9/30/2024

Sheet No.  
1 of 3

Plan Prepared for:  
Town of Montville, Connecticut

Camp Oakdale  
Public Works Equipment Storage Garage  
176 Meeting House Lane

Site Plan

10/7/2024

Issued for Permit

No. DATE REVISION

STATE OF CONNECTICUT

PROFESSIONAL ENGINEER

NO. 24226

CLA ENGINEERS, INC.



PROPOSED DEVELOPMENT

THE PROPOSED DEVELOPMENT INCLUDES A NEW METAL GARAGE BUILDING FOR USE BY THE TOWN PUBLIC WORKS DEPARTMENT TO STORE TRUCKS, TRAILERS, MOWERS, AND OTHER MAINTENANCE EQUIPMENT FOR USE AT THE CAMP OAKDALE PARK AND OTHER TOWN FACILITIES. THERE WILL BE NO BATHROOM FACILITIES PROPOSED AND NO WATER OR SEWER SERVICE PROPOSED. A GRAVEL DRIVEWAY AND GARAGE ACCESS WILL BE PROVIDED AS SHOWN ON THE SITE PLAN.

THE PROPOSED WORK WILL DISTURB APPROXIMATELY 0.41 ACRES.

- NO PORTION OF THE WORK AREA LIES WITHIN A 100-YEAR FLOOD PLAN.  
(FIRM MAP #0001103310 & #0001103320, EFFECTIVE 7/18/2011).
- THERE ARE NO INLAND WETLANDS WITHIN 50' OF THE PROPOSED WORK. THE NEAREST INLAND WETLANDS ARE LOCATED APPROXIMATELY 375' NORTHEAST OF THE DEVELOPMENT.
- NO PORTION OF THE SITE LIES WITHIN A CT DEEP NATURAL DIVERSITY DATABASE AREA.
- NO PORTION OF THE SITE LIES WITHIN THE COASTAL RESOURCE MANAGEMENT BOUNDARY.
- NO PORTION OF THE SITE LIES WITHIN A PUBLIC WATER SUPPLY WATERSHED.

GENERAL NOTES

- TOPOGRAPHY WAS ESTABLISHED BY CLA ENGINEERS, INC.
- CONTRACTOR SHALL CONTACT "CALL BEFORE YOU DIG" AT 811 AT LEAST 2 FULL WORKING DAYS PRIOR TO THE START OF CONSTRUCTION.
- INFORMATION SHOWN ON THE DRAWINGS RELATING TO MATERIALS, CONDITIONS, AND/OR LOCATIONS OF EXISTING STRUCTURES AND UTILITIES HAS BEEN COMPILED FROM AVAILABLE INFORMATION INCLUDING FIELD SURVEY, UTILITY COMPANY AND TOWN RECORD MAPS AND DRAWINGS, AND IS NOT GUARANTEED ACCURATE OR COMPLETE.
- THE CONTRACTOR SHALL EXCAVATE TEST PITS AS SHOWN ON THE PLANS, AS NEEDED, OR AS DIRECTED BY THE OWNER TO VERIFY UTILITY INFORMATION PRIOR TO THE START OF CONSTRUCTION.
- ALL PROPOSED WORK MAY BE VARIED IN THE FIELD BY THE OWNER TO MATCH EXISTING CONDITIONS.
- MAINTENANCE AND PROTECTION OF TRAFFIC:**
  - THE CONTRACTOR SHALL BE SOLELY RESPONSIBLE FOR ALL MAINTENANCE AND PROTECTION OF TRAFFIC, TRAFFIC CONTROL, TEMPORARY SIGNING OR BARRICADES, AND TEMPORARY LANE CLOSURES AS NEEDED. CONTINUOUS ACCESS FOR BUSES AND EMERGENCY VEHICLES SHALL BE MAINTAINED AT ALL TIMES.
  - PASSAGE OF TRAFFIC ON ROADWAYS: A MINIMUM OF ONE LANE FOR TRAFFIC SHALL BE MAINTAINED AT ALL TIMES. THE CONTRACTOR SHALL PERFORM HIS OPERATIONS TO MINIMIZE DISRUPTIONS TO TRAFFIC WITHIN AND AROUND THE PROJECT SITE.
  - THE CONTRACTOR MUST COORDINATE ANY TEMPORARY MODIFICATION TO TRAFFIC PATTERNS ALONG ROUTE 1 WITH THE STATE OF CONNECTICUT DOT DISTRICT 2 OFFICE.
  - TEMPORARY MODIFICATIONS TO TRAFFIC PATTERNS ON PUBLIC ROADWAYS SHALL CONFORM TO THE REQUIREMENTS OF CTDOT AND THE "MANUAL ON UNIFORM TRAFFIC CONTROL DEVICES (MUTCD)".
  - CONSTRUCTION SIGNS MUST CONFORM TO THE SIGNING REQUIREMENTS OUTLINED IN THE "MANUAL ON UNIFORM TRAFFIC CONTROL DEVICES (MUTCD)". ALL SIGN FACES SHALL BE REFLECTORIZED.
- THE CONTRACTOR SHALL CONFINE HIS OPERATIONS AND ACTIVITIES FOR CONSTRUCTION PURPOSES WITHIN THE STREET LINES, EASEMENTS AND PROPERTY AS SHOWN ON THE DRAWINGS. THE CONTRACTOR SHALL BE RESPONSIBLE FOR ANY DAMAGE TO EXISTING PAVEMENT, ROADWAY, SIDEWALKS, ETC., OUTSIDE OF THE WORK AREA AND SHALL REPAIR SUCH DAMAGE AT NO ADDITIONAL COST TO THE OWNER.
- UPON COMPLETION OF THE WORK, ALL DISTURBED AREAS SHALL BE RESTORED TO A CONDITION EQUAL TO OR BETTER THAN EXISTED PRIOR TO CONSTRUCTION.
- ALL STREET SIGNS, MAILBOXES, PLANTINGS, ORNAMENTAL OBJECTS, LIGHTS, LANDSCAPE SHRUBBERY, ETC., SHALL BE PROTECTED FROM DAMAGE AND SHALL BE REPLACED IN THE SAME OR BETTER CONDITION BY THE CONTRACTOR IF DISTURBED OR DAMAGED BY THE CONTRACTOR DURING CONSTRUCTION.
- THE CONTRACTOR SHALL BE RESPONSIBLE FOR THE TEMPORARY AND PERMANENT SUPPORT OF ALL EXISTING UTILITY POLES IN AN ADJACENT TO THE CONSTRUCTION AREA AND SHALL COMPLY WITH ALL THE REQUIREMENTS AND SPECIAL DETAILS FOR THE SUPPORT OF UTILITIES REQUIRED BY UTILITY AGENCIES. ALL COSTS FOR TEMPORARILY SUPPORTING UTILITY POLES DURING CONSTRUCTION SHALL BE INCLUDED IN OTHER ITEMS.
- MATERIAL STOCKPILE AND STAGING AREAS: THE CONTRACTOR SHALL UTILIZE THE STOCKPILE, MATERIAL STORAGE, AND EQUIPMENT STORAGE AREAS SHOWN ON THE PLANS. THE CONTRACTOR MAY ADJUST THE EXACT LOCATIONS IN THE FIELD AS NEEDED; STOCKPILE AND STAGING AREAS MUST REMAIN WITHIN THE PROPOSED LIMITS OF DISTURBANCE. PRIOR TO THE START OF CONSTRUCTION THE CONTRACTOR SHALL IDENTIFY THESE AREAS AND PROVIDE EROSION AND SEDIMENTATION CONTROL MEASURES AS REQUIRED.
- BLASTING SHALL NOT BE PERFORMED.
- THE CONTRACTOR SHALL BE RESPONSIBLE FOR RESETTING TO GRADE ALL FRAMES, GRATES, COVERS, VALVE BOXES, ACCESS COVERS, AND ALL OTHER ITEMS WHICH NORMALLY MUST HAVE A FIXED RELATION TO FINISHED GRADE.
- THE CONTRACTOR SHALL BE RESPONSIBLE FOR ALL CONSTRUCTION SURVEY AND STAKEOUT AS THEY NEED. CONTROL POINT INFO AND CAD FILES OF THE SITE PLAN CAN BE PROVIDED PRIOR TO CONSTRUCTION.
- ALL WORK TO CONFORM TO THE STATE OF CONNECTICUT DEPARTMENT OF TRANSPORTATION STANDARD SPECIFICATIONS FOR ROADS, BRIDGES AND INCIDENTAL CONSTRUCTION FORM 819, DATED JANUARY 2024, AS REVISED.

EROSION & SEDIMENTATION CONTROL NARRATIVE:

- THE EROSION & SEDIMENTATION CONTROL PLAN AND DETAILS HAVE BEEN DEVELOPED AS A STRATEGY TO CONTROL SOIL EROSION AND SEDIMENTATION DURING AND AFTER CONSTRUCTION. THIS PLAN IS BASED ON THE "CONNECTICUT GUIDELINES FOR SOIL EROSION AND SEDIMENT CONTROL" EFFECTIVE MARCH 30, 2024 BY THE COUNCIL ON SOIL AND WATER CONSERVATION IN COLLABORATION WITH CONNECTICUT DEPARTMENT OF ENERGY AND ENVIRONMENTAL PROTECTION.
- THE PROPOSED LOCATIONS OF SILTATION AND EROSION CONTROL MEASURES ARE SHOWN ON THE PLANS. THE CONTRACTOR SHALL PROVIDE SILT FENCE, STONE CHECK DAMS AND/OR OTHER EROSION CONTROL MEASURES AS NEEDED OR DIRECTED BY THE ENGINEER OR TOWN STAFF TO ADEQUATELY PREVENT SEDIMENT TRANSPORT.
- EROSION AND SEDIMENTATION CONTROL MEASURES SHALL BE INSTALLED PRIOR TO SITE DISTURBANCE.
- THE CONTRACTOR SHALL INSPECT, REPAIR AND/OR REPLACE EROSION CONTROL MEASURES EVERY 7 DAYS AND IMMEDIATELY FOLLOWING ANY SIGNIFICANT RAINFALL OR SNOW MELT. SEDIMENT DEPOSITS MUST BE REMOVED WHEN WHEN DEPOSITS REACH APPROXIMATELY ONE HALF THE HEIGHT OF THE BARRIER. SEDIMENT CONTROL DEVICES SHALL REMAIN IN PLACE AND BE MAINTAINED BY THE CONTRACTOR UNTIL AREAS UPSLOPE ARE PERMANENTLY STABILIZED.
- STAKED HAY BALE SILT BARRIERS OR SILT FENCE SHALL BE INSTALLED AROUND ANY TEMPORARY STOCKPILE AREAS. TEMPORARY VEGETATIVE COVER MAY BE REQUIRED (SEE NOTE).
- INLET SEDIMENTATION CONTROL DEVICES SHALL BE INSTALLED UNDER THE GRATES OF ALL EXISTING CATCH BASINS IN THE CONSTRUCTION AREA.
- CONTINUOUS DUST CONTROL USING WATER, CALCIUM CHLORIDE OR APPROVED EQUAL SHALL BE PROVIDED FOR ALL EARTH STOCKPILES, EARTH PILED ALONG EXCAVATIONS, SURFACES OF BACKFILLED TRENCHES AND GRAVELED ROADWAY SURFACES.
- IF DEWATERING IS NECESSARY DURING ANY TIME OF CONSTRUCTION A CLEAR WATER DISCHARGE SHALL BE PROVIDED AS PROPOSED BY THE CONTRACTOR AND APPROVED BY THE ENGINEER.
- ALL DISTURBED AREAS SHALL BE RESTORED PER THE SLOPE STABILIZATION AND PERMANENT VEGETATION DETAILS. ALL DISTURBED AREAS THAT ARE SLOPED LESS THAN THREE HORIZONTAL TO ONE VERTICAL (3:1) SLOPE SHALL BE LOAMED, SEEDED, FERTILIZED AND MULCHED PER THE PERMANENT VEGETATIVE COVER SPECIFICATIONS. EROSION CONTROL MATTING SHALL BE PROVIDED ON ALL DISTURBED AREAS THAT ARE SLOPED MORE THAN THREE HORIZONTAL TO ONE VERTICAL (3:1).
- IF FINAL SEEDING OF DISTURBED AREAS IS NOT TO BE COMPLETED BEFORE OCTOBER 15, THE CONTRACTOR SHALL PROVIDE TEMPORARY MULCHING (DORMANT SEEDING MAY BE ATTEMPTED AS WELL) TO PROTECT THE SITE AND DELAY PERMANENT SEEDING.
- WHEN FEASIBLE, TEMPORARY SEEDING OF DISTURBED AREAS THAT HAVE NOT BEEN FINISHED GRADED SHALL BE COMPLETED PRIOR TO OCTOBER 15.
- ANY EROSION WHICH OCCURS WITHIN THE DISTURBED AREAS SHALL BE IMMEDIATELY REPAIRED AND STABILIZED. DURING THE CONSTRUCTION PHASE, INTERCEPTED SEDIMENT SHALL BE RETURNED TO THE SITE. POST SEEDING, INTERCEPTED SEDIMENT, IF ANY, SHALL BE DISPOSED OF IN A MANNER APPROVED BY THE TOWN AND ENGINEER.
- EROSION AND SEDIMENTATION CONTROL MEASURES SHALL REMAIN IN PLACE UNTIL VEGETATION IS RE-ESTABLISHED OR SLOPES ARE STABILIZED AND REMOVAL IS APPROVED BY THE TOWN.
- UNFORESEEN PROBLEMS WHICH ARE ENCOUNTERED IN THE FIELD SHALL BE SOLVED ACCORDING TO THE "CONNECTICUT GUIDELINES FOR SOIL EROSION AND SEDIMENT CONTROL" EFFECTIVE MARCH 30, 2024 BY THE COUNCIL ON SOIL AND WATER CONSERVATION IN COLLABORATION WITH CONNECTICUT DEPARTMENT OF ENERGY AND ENVIRONMENTAL PROTECTION.
- IF NECESSARY, THE TOWN WILL BE PREPARED TO STEP IN AND TAKE ACTION TO ADDRESS ANY POTENTIAL EROSION PROBLEMS. ANY WORK DONE BY THE TOWN WILL BE BACK CHARGED TO THE CONTRACTOR.
- DURING CONSTRUCTION THE CONTRACTOR SHALL PROVIDE THE NAME AND CONTACT INFORMATION FOR THE PROJECT PERSONNEL RESPONSIBLE FOR EROSION AND SEDIMENTATION CONTROLS.

JOHN CARLSON, DIRECTOR OF PUBLIC WORKS  
860-848-7473  
jcarlson@montville-ct.org
- PUBLIC WORKS CONTACT FOR ISSUES WITH EROSION & SEDIMENTATION CONTROLS

STORMWATER MANAGEMENT & POLLUTION PREVENTION PLAN

- DURING CONSTRUCTION**
- POLLUTION PREVENTION TEAM:**

THE CONTRACTOR SHALL BE RESPONSIBLE FOR CARRYING OUT THE PROVISIONS OF THIS PLAN.
  - SWEEPING:**

PARKING LOTS, SIDEWALKS AND OTHER IMPERVIOUS SURFACES BEYOND THE WORK SITE SHALL BE SWEEPED CLEAN OF SAND, SILT AND LITTER DAILY AT THE END OF THE WORK DAY.
  - OUTSIDE STORAGE:**

ACCESSORIES OR EQUIPMENT STORED OUTSIDE SHALL BE COVERED OR MAINTAINED TO MINIMIZE POSSIBILITY OF THESE MATERIALS OR THEIR RESIDUE PASSING TO STORM WATER.
  - WASHING:**

NO WASHING OF VEHICLES, ACCESSORIES, EQUIPMENT, OR APPLIANCES IN THE WORK SITE.
  - MAINTENANCE AND INSPECTION:**

A. THE CONTRACTOR SHALL INSPECT, REPAIR AND/OR REPLACE EROSION CONTROL MEASURES EVERY 7 DAYS AND IMMEDIATELY FOLLOWING ANY RAINFALL OF ½" OR MORE, OR SIGNIFICANT SNOW MELT.

B. SEDIMENT DEPOSITS MUST BE REMOVED AND DISPOSED OF WHEN THEY REACH ONE HALF THE HEIGHT OF THE SILT FENCE, HAY BALE BARRIER, OR STRAW WATTLE.

C. DAILY DUST CONTROL USING WATER, CALCIUM CHLORIDE OR APPROVED EQUAL SHALL BE PROVIDED FOR ALL EARTH STOCKPILES, EARTH PILED ALONG EXCAVATIONS, SURFACES OF BACKFILLED TRENCHES AND GRAVELED SURFACES.
  - FUELING OF VEHICLES AND EQUIPMENT:**

REFUELING SHALL BE DONE OVER A TEMPORARY PORTABLE SPILL CONTAINMENT BERM.
  - SPILLS OR ACCIDENTAL DISCHARGES:**

A. COMPLY WITH STATE AND FEDERAL REGULATIONS TO CONTAIN AND CLEAN UP ANY SPILL OR DISCHARGE AND DISPOSE OF MATERIALS AT AN APPROVED FACILITY.

B. CONTACT CONNECTICUT DEEP OIL AND CHEMICAL SPILL RESPONSE DIVISION: (860) 424-3338

C. THE FOLLOWING STEPS SHOULD BE PERFORMED AS SOON AS POSSIBLE:

    - STOP THE SOURCE OF THE SPILL
    - CONTAIN THE SPILL
    - COVER SPILL WITH ABSORBENT MATERIAL SUCH AS KITTY LITER, SAWDUST OR OIL ABSORBENT PADS. DO NOT USE STRAW.
    - DISPOSE OF ABSORBER IN ACCORDANCE WITH LOCAL AND STATE REGULATIONS.
- POST CONSTRUCTION**
- POLLUTION PREVENTION TEAM:**

THE OWNER SHALL BE RESPONSIBLE FOR CARRYING OUT THE PROVISIONS OF THIS PLAN.
  - SWEEPING / CLEANING:**

SIDEWALKS AND OTHER IMPERVIOUS SURFACES SHALL BE SWEEPED CLEAN OF SAND AND LITTER AND ANY OTHER POLLUTANTS AT LEAST TWICE PER YEAR. LOOSE LITTER SHALL BE REMOVED DAILY.
  - OUTSIDE STORAGE:**

ACCESSORIES OR EQUIPMENT STORED OUTSIDE SHALL BE COVERED OR MAINTAINED TO MINIMIZE POSSIBILITY OF THESE MATERIALS OR THEIR RESIDUE PASSING TO STORM WATER.
  - WASHING:**

NO WASHING OF VEHICLES, ACCESSORIES, EQUIPMENT OR APPLIANCES IN PARKING AREAS.
  - MAINTENANCE AND INSPECTION:**

INSPECT THE SITE FOR POTENTIAL EROSION AFTER RAIN EVENTS. RESTORE ERODED AREAS WITH TOPSOIL AND SEED, OR CRUSHED STONE SURFACING AS NEEDED
  - FUELING OF VEHICLES AND EQUIPMENT:**

REFUELING OF VEHICLES AND EQUIPMENT SHALL TAKE PLACE WITHIN THE GARAGE
  - SPILLS OR ACCIDENTAL DISCHARGES:**

A. COMPLY WITH STATE AND FEDERAL REGULATIONS TO CONTAIN AND CLEAN UP ANY SPILL OR DISCHARGE AND DISPOSE OF MATERIALS AT AN APPROVED FACILITY.

B. CONTACT CONNECTICUT DEEP OIL AND CHEMICAL SPILL RESPONSE DIVISION: (860) 424-3338

C. THE FOLLOWING STEPS SHOULD BE PERFORMED AS SOON AS POSSIBLE:

    - STOP THE SOURCE OF THE SPILL
    - CONTAIN THE SPILL
    - COVER SPILL WITH ABSORBENT MATERIAL SUCH AS KITTY LITER, SAWDUST OR OIL ABSORBENT PADS. DO NOT USE STRAW.
    - DISPOSE OF ABSORBER IN ACCORDANCE WITH LOCAL AND STATE REGULATIONS.

TEMPORARY VEGETATIVE COVER

A TEMPORARY SEEDING OF RYE GRASS WILL BE COMPLETED WITHIN 15 DAYS OF THE FORMATION OF STOCKPILES. IF THE SOIL IN THE STOCKPILES HAS BEEN COMPACTED BY CONSTRUCTION OPERATIONS IT SHALL BE LOOSENEED TO A DEPTH OF 2 INCHES BEFORE THE FERTILIZER, LIME AND SEED IS APPLIED. 10-10-10 FERTILIZER AT A RATE OF 7.5 POUNDS PER 1000 S.F. LIME AT A RATE OF 90 LBS. PER 1000 S.F. SHALL BE USED. RYE GRASS APPLIED AT A RATE OF 1 LB. PER 1000 S.F. SHALL PROVIDE THE TEMPORARY VEGETATIVE COVER. STRAW FREE FROM WEEDS AND COARSE MATTER SHALL BE USED AT A RATE OF 70-90 LBS. PER 1000 S.F. AS A TEMPORARY MULCH. APPLY MULCH AND DRIVE TRACKED EQUIPMENT UP AND DOWN SLOPE OVER ENTIRE SURFACE SO CLEAT MARKS ARE PARALLEL TO THE CONTOURS.

PERMANENT VEGETATIVE COVER

TOPSOIL WILL BE REPLACED ONCE THE EXCAVATIONS HAVE BEEN COMPLETED AND THE SLOPES ARE GRADED AS SHOWN ON THE PLANS. PROVIDE SLOPE PROTECTION AS CALLED FOR ON THE PLANS AND DETAILS. TOPSOIL SHALL BE SPREAD AT A MINIMUM COMPACTED DEPTH OF 6 INCHES. ONCE THE TOPSOIL HAS BEEN SPREAD, ALL STONES TWO INCHES OR LARGER IN ANY DIMENSION WILL BE REMOVED AS WELL AS DEBRIS.

- APPLY AGRICULTURAL GROUND LIME AT THE RATE OF TWO TONS PER ACRE OR 100 LBS. PER 1000 S.F.
- APPLY 10-10-10 FERTILIZER OR EQUIVALENT AT A RATE OF 300 LBS. PER ACRE OR 7.5 LBS. PER 1000 S.F.
- WORK LIME AND FERTILIZER INTO THE SOIL TO A DEPTH OF 4 INCHES.
- INSPECT SEEDBED BEFORE SEEDING.
- IF TRAFFIC HAS COMPACTED THE SOIL, RETILL COMPACTED AREAS.
- APPLY THE FOLLOWING GRASS SEED MIX:

TYPICAL SEED MIXTURE

ALL DISTURBED AREAS	LBS./ACRE	LBS./1000 S.F.
KENTUCKY BLUEGRASS	20	0.45
CREeping RED FESCUE	20	0.45
PERENNIAL RYEGRASS	5	0.10
	45	1.00

TYPICAL SEED MIXTURE FOR NON-MOWED SLOPES (3:1 OR STEEPER)

CT DEP SEED MIX NO. 28	LBS./ACRE	LBS./1000 S.F.
SWITCHGRASS (BLACKWELL, SHELTER, CAVE-IN-ROCK)	4.0	0.10
BIG BLUESTEM (NIAGARA, KAW)	4.0	0.10
LITTLE BLUESTEM (BLAZE, ALDOUS, CAMPER)	2.0	0.05
SAND LOVEGRASS (NE-27, BEND)	1.5	0.03
BIRD'S-FOOT TREFOL (EMPIRE VIKING)	2.0	0.05
	13.5	0.33

THE RECOMMENDED SEEDING DATES ARE:  
APRIL 1 - JUNE 15 AND AUGUST 15 - OCTOBER 15

IMMEDIATELY FOLLOWING SEEDING, FIRM SEED BED WITH A ROLLER AND MULCH WITH WEED FREE STRAW. IF PERMANENT VEGETATIVE COVER IS HAS NOT BEEN ESTABLISHED BY OCTOBER 15, APPLY A TEMPORARY VEGETATIVE COVER ON THE TOPSOIL.

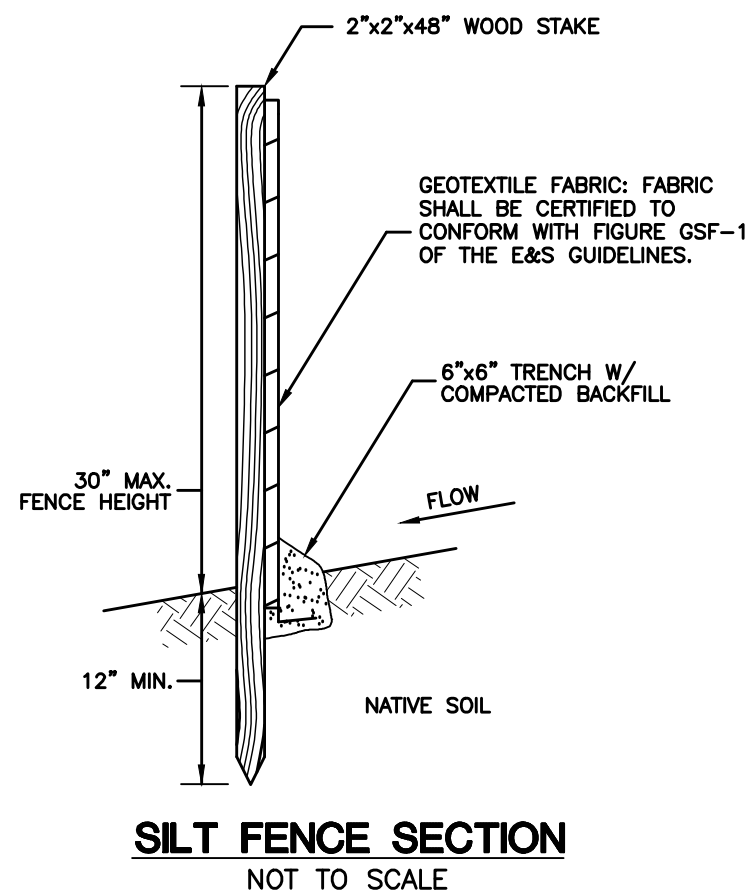

SILT FENCE SECTION  
NOT TO SCALE

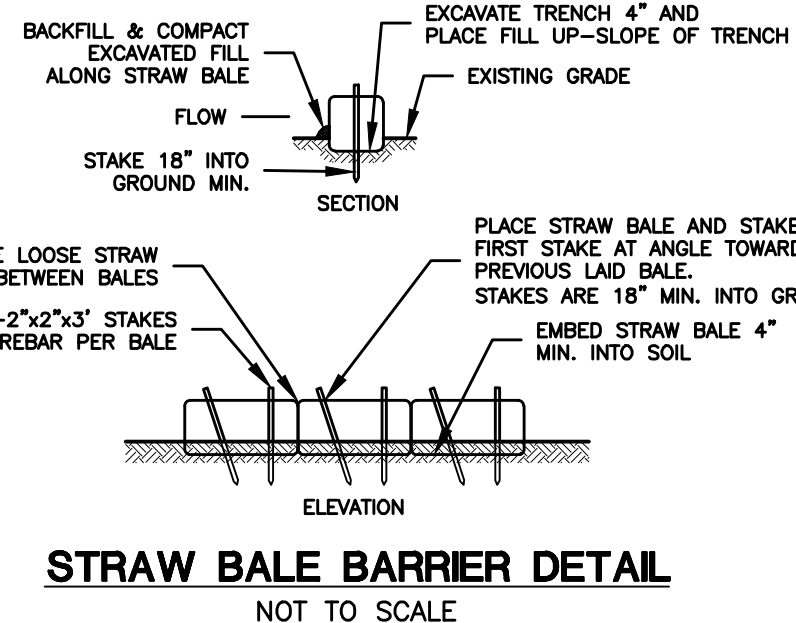

STRAW BALE BARRIER DETAIL  
NOT TO SCALE

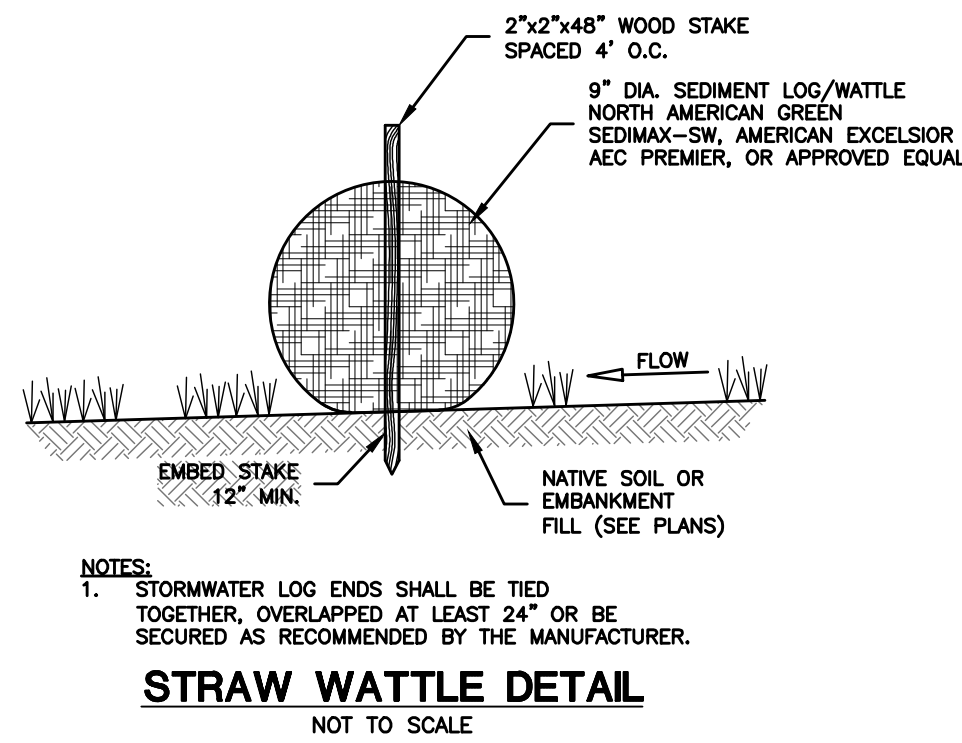

STRAW WATTLE DETAIL  
NOT TO SCALE

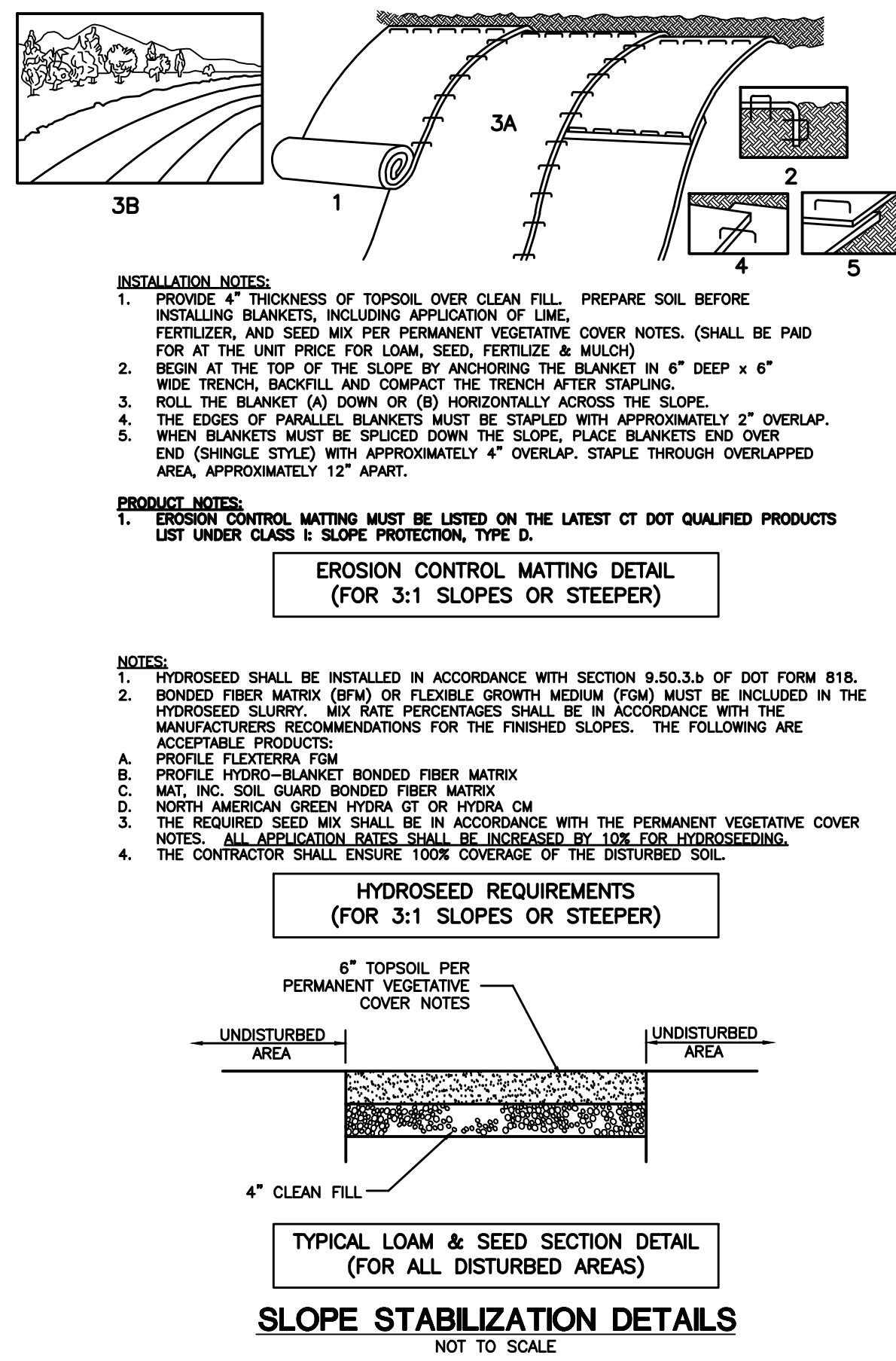

SLOPE STABILIZATION DETAILS  
NOT TO SCALE

- INSTALLATION NOTES:**
- PROVIDE 4" THICKNESS OF TOPSOIL OVER CLEAN FILL. PREPARE SOIL BEFORE INSTALLING BLANKETS, INCLUDING APPLICATION OF LIME, FERTILIZER, AND SEED MIX PER PERMANENT VEGETATIVE COVER NOTES. (SHALL BE PAID FOR AT THE UNIT PRICE FOR LOAM, SEED, FERTILIZE & MULCH)
  - BEGIN AT THE TOP OF THE SLOPE BY ANCHORING THE BLANKET IN 6" DEEP x 6" WIDE TRENCH, BACKFILL AND COMPACT THE TRENCH AFTER STAPLING.
  - ROLL THE BLANKET (A) DOWN OR (B) HORIZONTALLY ACROSS THE SLOPE.
  - THE EDGES OF PARALLEL BLANKETS MUST BE STAPLED WITH APPROXIMATELY 2" OVERLAP.
  - WHEN BLANKETS MUST BE SPICLED DOWN THE SLOPE, PLACE BLANKETS END OVER END (SHINGLE STYLE) WITH APPROXIMATELY 4" OVERLAP. STAPLE THROUGH OVERLAPPED AREA, APPROXIMATELY 12" APART.
- PRODUCT NOTES:**
- EROSION CONTROL MATTING MUST BE LISTED ON THE LATEST CT DOT QUALIFIED PRODUCTS LIST UNDER CLASS I: SLOPE PROTECTION, TYPE D.

EROSION CONTROL MATTING DETAIL  
(FOR 3:1 SLOPES OR STEEPER)

HYDROSEED REQUIREMENTS  
(FOR 3:1 SLOPES OR STEEPER)

- NOTES:**
- HYDROSEED SHALL BE INSTALLED IN ACCORDANCE WITH SECTION 9.50.3.b OF DOT FORM 818.
  - BONDED FIBER MATRIX (BFM) OR FLEXIBLE GROWTH MEDIUM (FGM) MUST BE INCLUDED IN THE HYDROSEED SLURRY. MIX RATE PERCENTAGES SHALL BE IN ACCORDANCE WITH THE MANUFACTURERS RECOMMENDATIONS FOR THE FINISHED SLOPES. THE FOLLOWING ARE ACCEPTABLE PRODUCTS:
- A. PROFILE FLEXTERRA FGM  
B. PROFILE HYDRO-BLANKET BONDED FIBER MATRIX  
C. MAT, INC. SOIL GUARD BONDED FIBER MATRIX  
D. NORTH AMERICAN GREEN HYDRA GT OR HYDRA CM  
E. THE REQUIRED SEED MIX SHALL BE IN ACCORDANCE WITH THE PERMANENT VEGETATIVE COVER NOTES. ALL APPLICATION RATES SHALL BE INCREASED BY 10% FOR HYDROSEEDING.  
F. THE CONTRACTOR SHALL ENSURE 100% COVERAGE OF THE DISTURBED SOIL.

APPROVED BY THE MONTVILLE PLANNING AND ZONING COMMISSION

CHAIRMAN, VICE CHAIRMAN, OR SECRETARY OF THE COMMISSION DATE

10/7/2024		Issued for Permit	
No.	DATE	REVISION	
<b>CLA Engineers, Inc.</b> CIVIL • STRUCTURAL • SURVEYING 317 Main Street Norwich, CT 06360 (860) 886-1966 Fax (860) 886-9165			
Project No. CLA-6314S		Project Engineer K.J.H.	
Date: 9/30/2024		Sheet No. 2 of 3	
Town of Montville, Connecticut <b>Camp Oakdale</b> <b>Public Works Equipment Storage Garage</b> <b>176 Meeting House Lane</b> Construction Details & Notes			





CONCEPTUAL BUILDING RENDERING  
NOT TO SCALE

BUILDING DESIGN LOAD TABLE

FLOOR LIVE LOADS		
OCCUPANCY OR USE	UNIFORM LOAD (PSF)	CONCENTRATED LOAD (LBS)
COMMERCIAL SLAB-ON-GRADE	125	2000
ROOF LIVE LOADS (SNOW)		
GROUND SNOW LOAD (Pg)	30 PSF	
FLAT ROOF SNOW LOAD (Pf)	30 PSF	
SNOW EXPOSURE FACTOR (Ce)	0.9	
IMPORTANCE FACTOR (Ia)	1.0	
THERMAL FACTOR (Ct)	1.2	
WIND LOADS		
BASIC WIND SPEED (3-SEC)	120 MPH	
IMPORTANCE FACTOR (Iw)	1.0	
WIND EXPOSURE	B	
INTERNAL PRESSURE COEFFICIENT	+/- 0.18	
COMPONENTS & CLADDING	PER EQUATION 16-35 OF IBC 2003-TABLE 1609.6.2.1(2)	
SEISMIC (EARTHQUAKE) LOADS		
IMPORTANCE FACTOR (Ie)	1.0	
MAPPED SPECTRAL RESPONSE ACCELERATION		
Ss	0.247	
S1	0.077	
SITE CLASSIFICATION	C	
SPECTRAL RESPONSE COEFFICIENT		
Sds	0.198	
Sd1	0.087	
SEISMIC DESIGN CATEGORY	B	

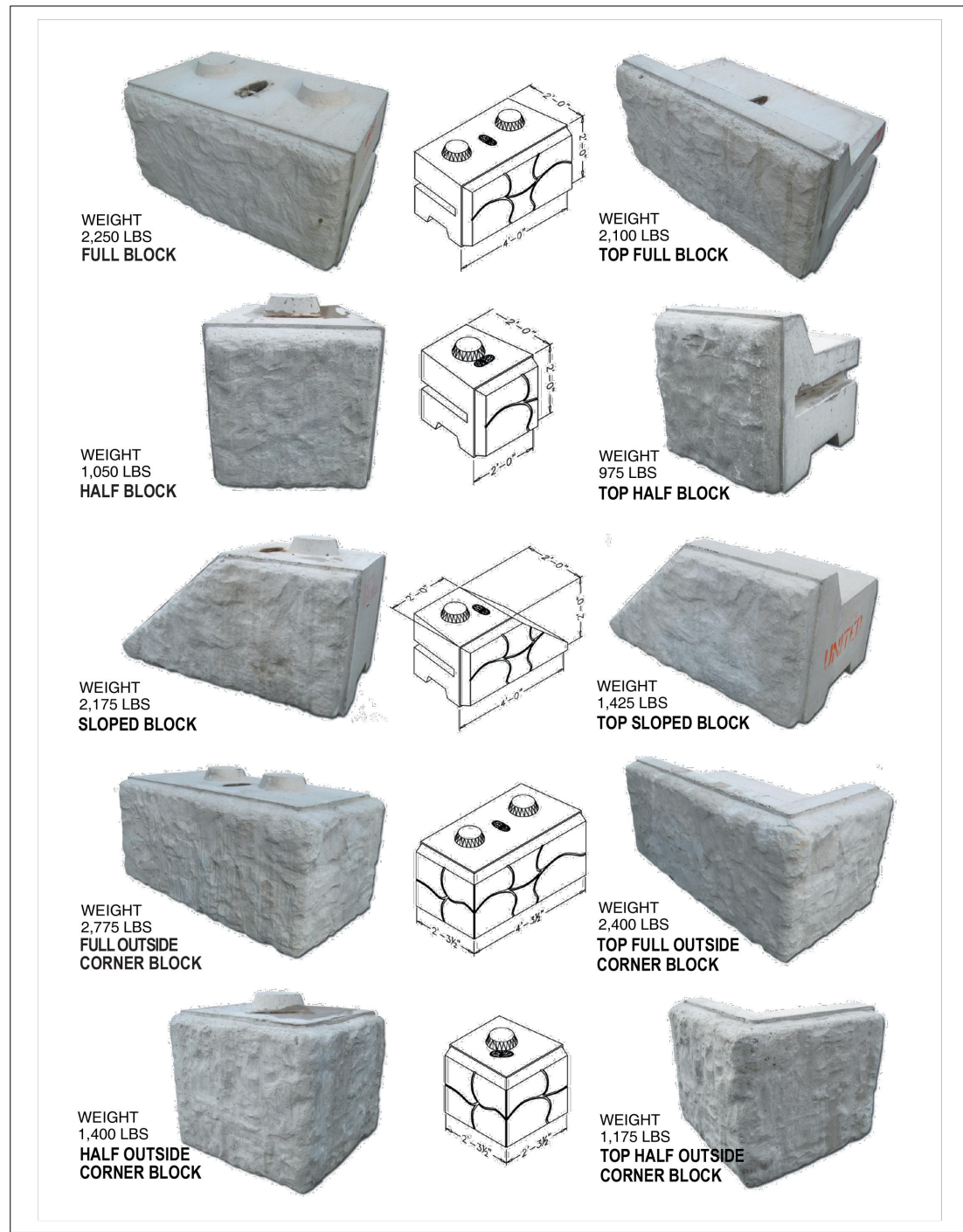

TYPICAL WALL COMPONENTS

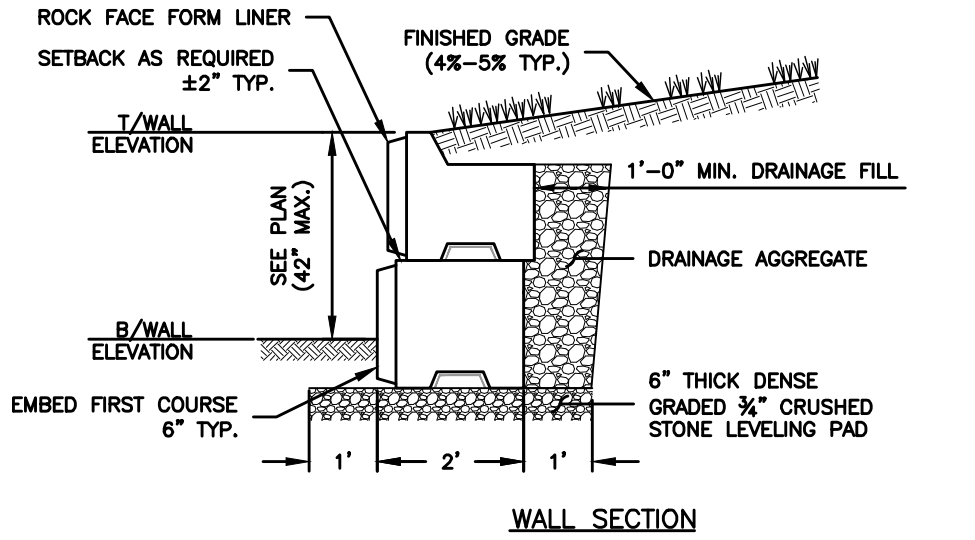

WALL SECTION

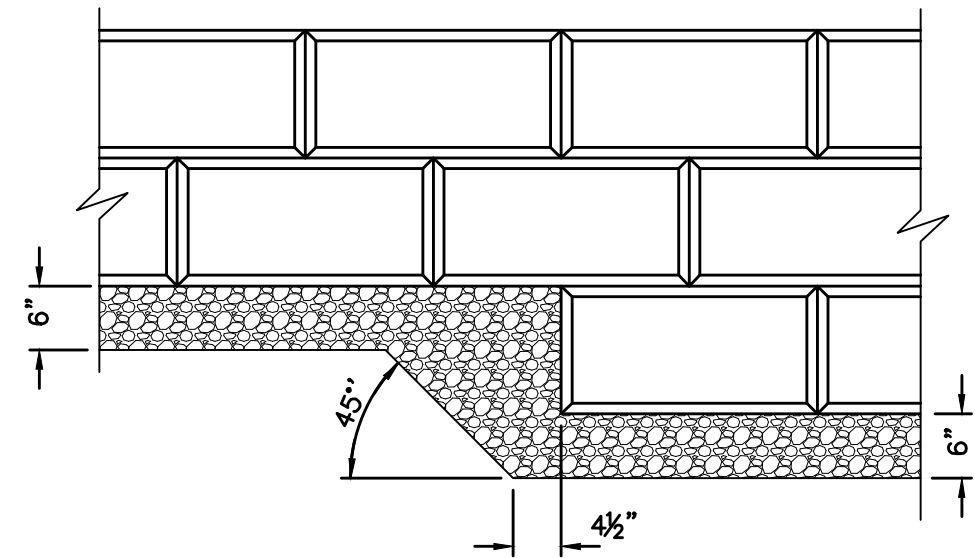

LEVELING PAD - BASE STEP DETAIL

- NOTES:
1. WALL SHALL BE EZ-BLOCK BY UNITED CONCRETE, OR APPROVED EQUAL
  2. FINAL DESIGN OF WALL TO BE APPROVED BY MANUFACTURERS ENGINEER PRIOR TO INSTALLATION.

MODULAR CONCRETE BLOCK RETAINING WALL DETAILS

NOT TO SCALE

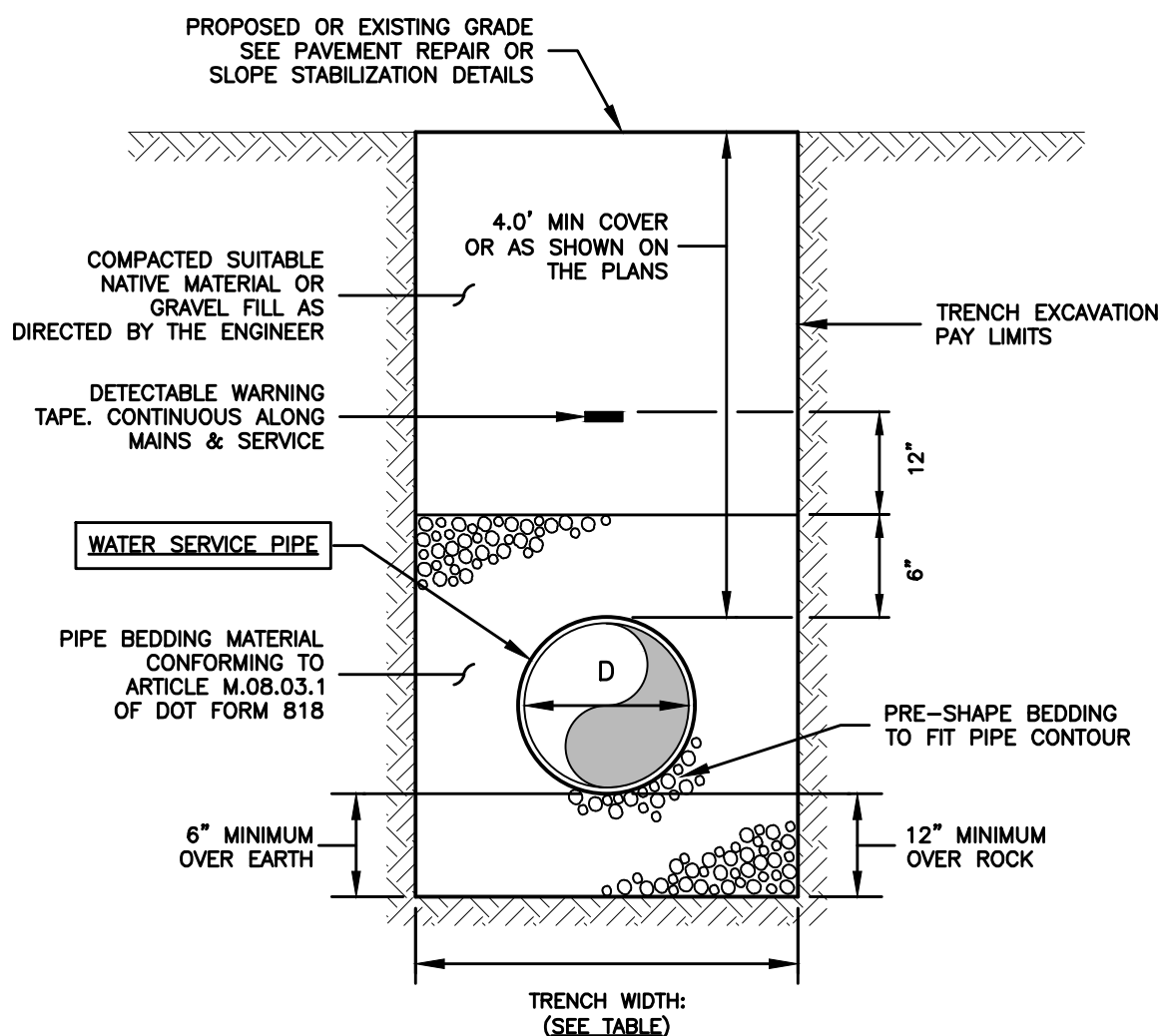

- NOTES:
1. D=INSIDE DIAMETER OF PIPE.
  2. TRENCH WIDTHS NOTED ARE SET TO ESTABLISH PAY LIMITS ONLY.
  3. ALL EXCAVATIONS MUST MEET OSHA STANDARDS.
  4. CONTRACTOR TO PROVIDE COMPACTION ON ALL TRENCH BACKFILLS, EXCAVATIONS AND PAVEMENT BASES TO NOT LESS THAN 95% OF THE DRY DENSITY FOR THAT MATERIAL.
  5. BEDDING MATERIAL TO CONFORM TO M.08.03.1 AS PER CT DOT FORM 818.

TRENCH DETAIL: IRRIGATION SERVICE RELOCATION

NOT TO SCALE

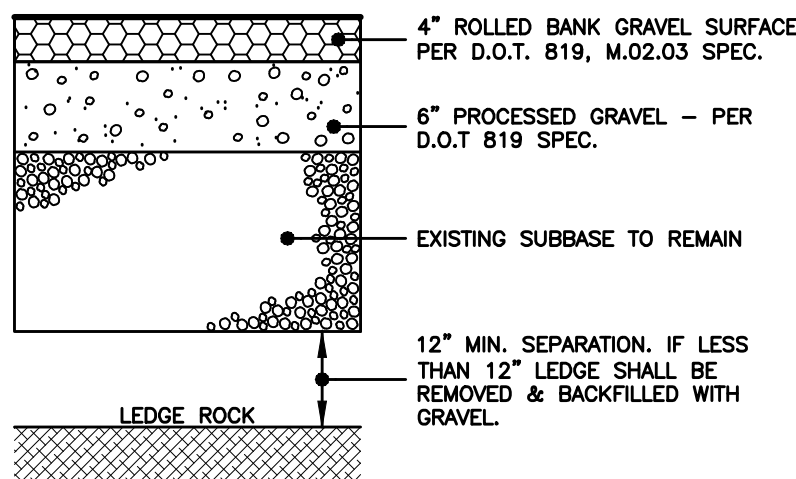

- NOTES:
1. CONTRACTOR TO PROVIDE COMPACTION ON ALL TRENCH BACKFILLS, EXCAVATIONS AND PAVEMENT BASES TO NOT LESS THAN 95% OF THE DRY DENSITY FOR THAT MATERIAL WHEN TESTED IN ACCORDANCE WITH AASHTO T180, METHOD D

TYPICAL GRAVEL SURFACE SECTION DETAIL

NOT TO SCALE

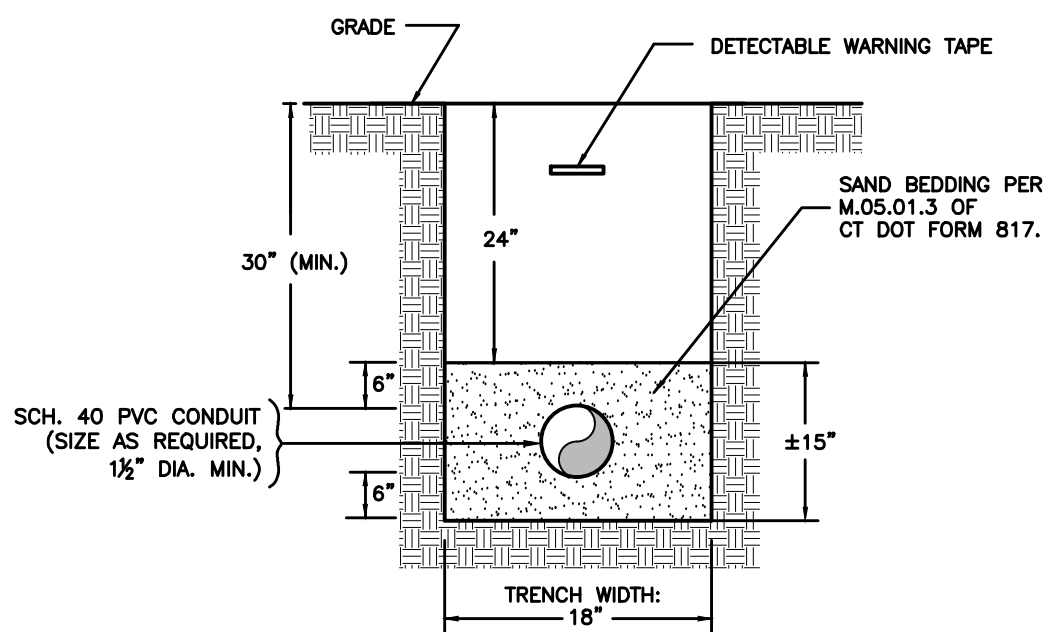

- NOTES:
1. TRENCH WIDTHS NOTED ARE SET TO ESTABLISH PAY LIMITS ONLY.
  2. ALL EXCAVATIONS MUST MEET OSHA STANDARDS.
  3. CONTRACTOR TO PROVIDE COMPACTION ON ALL TRENCH BACKFILLS, EXCAVATIONS AND PAVEMENT BASES TO NOT LESS THAN 95% OF THE DRY DENSITY FOR THAT MATERIAL.
  4. MAINTAIN 2" SEPARATION BETWEEN MULTIPLE CONDUIT TRENCHES, USE SPACERS AS NEEDED.
  5. CONDUITS SPACERS SHALL BE "WUNPEECS", CARLON SNAP LOCK OR "DUCT DONUT" CONDUIT SPACER BY UNDERGROUND DEVICES OR APPROVED EQUAL. SPACING SHALL BE PER THE MANUFACTURERS RECOMMENDATIONS, 5' TYP.

TRENCH DETAIL: SAND BEDDED CONDUIT

NOT TO SCALE

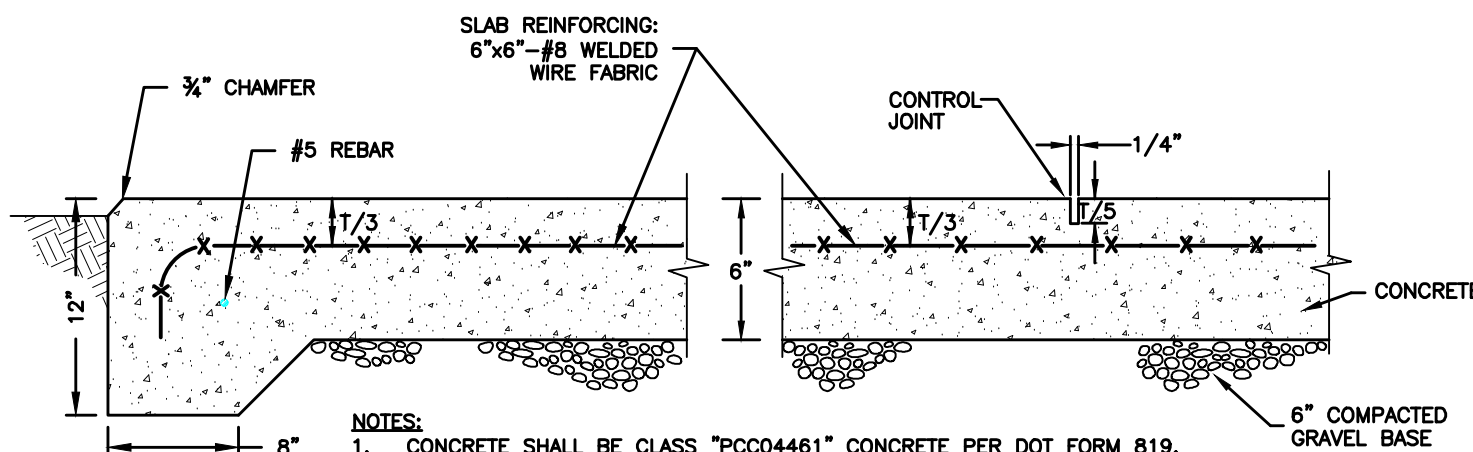

- NOTES:
1. CONCRETE SHALL BE CLASS "PC034481" CONCRETE PER DOT FORM 819.
  2. CONTROL JOINTS SHALL BE INSTALLED AT 4' O.C.
  3. PROVIDE A MINIMUM 1' LAP JOINT FOR WELDED WIRE FABRIC AS NEEDED.

CONCRETE APRON DETAIL

NOT TO SCALE

APPROVED BY THE MONTVILLE PLANNING AND ZONING COMMISSION

CHAIRMAN, VICE CHAIRMAN, OR SECRETARY OF THE COMMISSION DATE

**CLA Engineers, Inc.**  
CIVIL • STRUCTURAL • SURVEYING

317 Main Street Norwich, CT 06360  
(860) 886-1966 Fax (860) 886-9165

Plan Prepared for:  
Town of Montville, Connecticut  
**Camp Oakdale**  
Public Works Equipment Storage Garage  
176 Meeting House Lane

Construction Details & Notes

Project No.  
CLA-6314S  
Proj. Engineer  
K.J.H.  
Date:  
9/30/2024  
Sheet No.

3 of 3