

- SITING COUNCIL NOTES**
- THE PROPOSED DEVELOPMENT OF A 0.99-MEGAWATT AC SOLAR PHOTOVOLTAIC ARRAY ON THE PROPERTY OF 958 ROUTE 163 IN MONTVILLE, CT WAS SUBMITTED TO THE CONNECTICUT SITING COUNCIL AS PETITION NO. 1601 ON NOVEMBER 14, 2023. THE CONNECTICUT SITING COUNCIL APPROVED THE PETITION AND ISSUED ITS FINAL DECISION AND STAFF REPORT ON MAY 10, 2024.
 - A RECORD OF THE SUBMITTED MATERIALS FOR PETITION NO. 1601 CAN BE FOUND ON THE CONNECTICUT SITING COUNCIL'S WEBSITE AT [PORTAL.CT.GOV/CSC](https://portal.ct.gov/CSC).
 - A REGISTRATION FOR COVERAGE UNDER THE GENERAL PERMIT FOR THE DISCHARGE OF STORMWATER AND DEWATERING WASTEWATERS FROM CONSTRUCTION ACTIVITIES WAS SUBMITTED TO THE CONNECTICUT DEPARTMENT OF ENERGY AND ENVIRONMENTAL PROTECTION AND APPROVED ON AUGUST 22, 2024.
 - APPROVAL FOR AN ENCROACHMENT PERMIT FOR WORK WITHIN THE STATE RIGHT-OF-WAY WAS ISSUED FOR THE PROJECT ON SEPTEMBER 3, 2024 BY THE CONNECTICUT DEPARTMENT OF TRANSPORTATION.

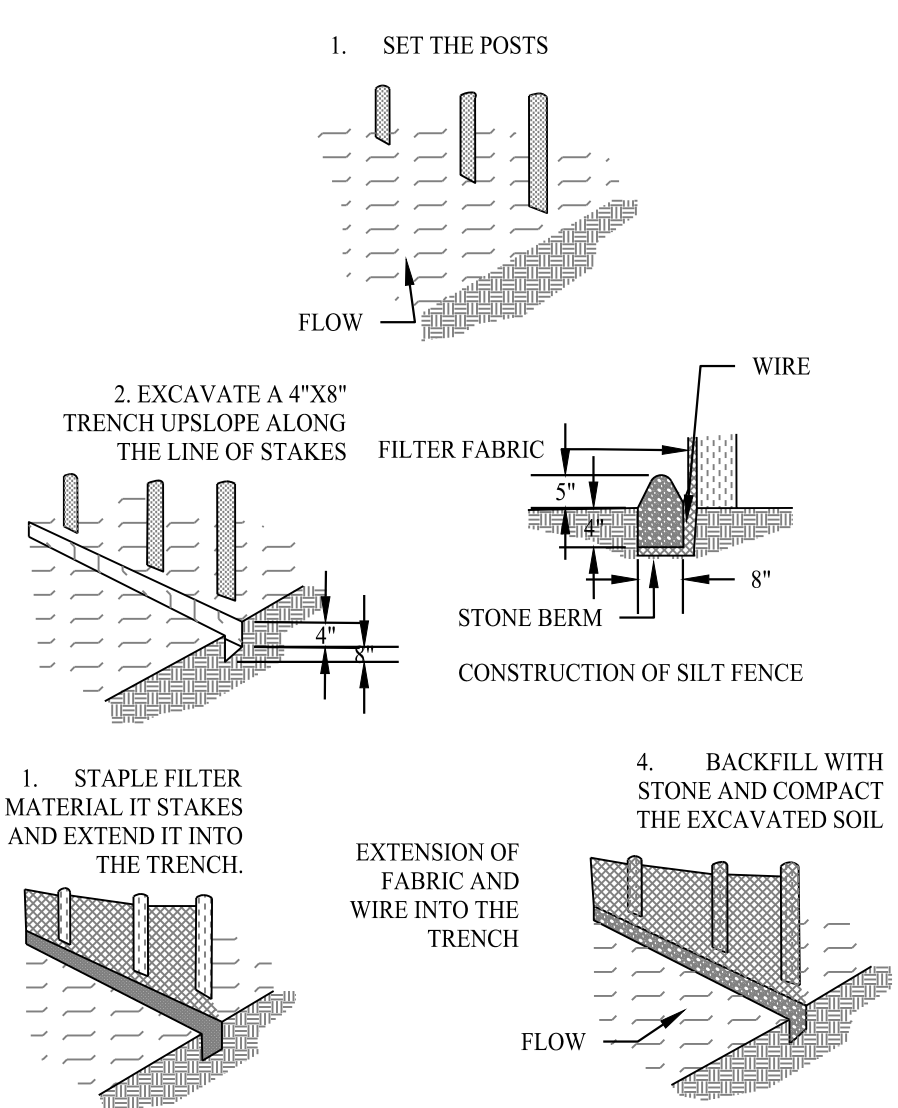

SILT FENCE DETAIL
SCALE: NTS

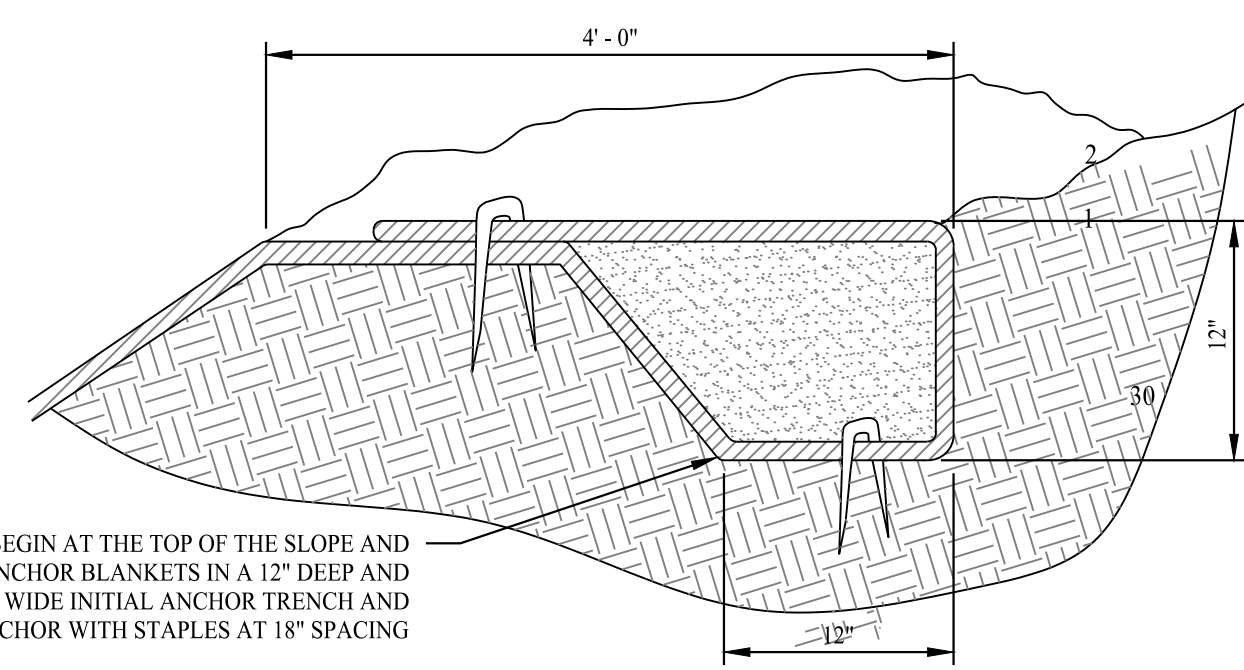

- NOTES:**
- SINGLE-NETED STRAW BLANKETS TO BE TYPICALLY USED ON SLOPES 3:1 AND FLATTER AS WELL AS IN LOW FLOW CHANNELS.
 - INSTALLATION TO BE COMPLETED IN ACCORDANCE WITH MANUFACTURER'S SPECIFICATIONS.
 - PRODUCT TO BE STRAW BLANKET WITH SINGLE BIODEGRADABLE NETTING (OR APPROVED EQUAL).
 - TOP NETTING MESH SIZE = 1/2" x 1/2".

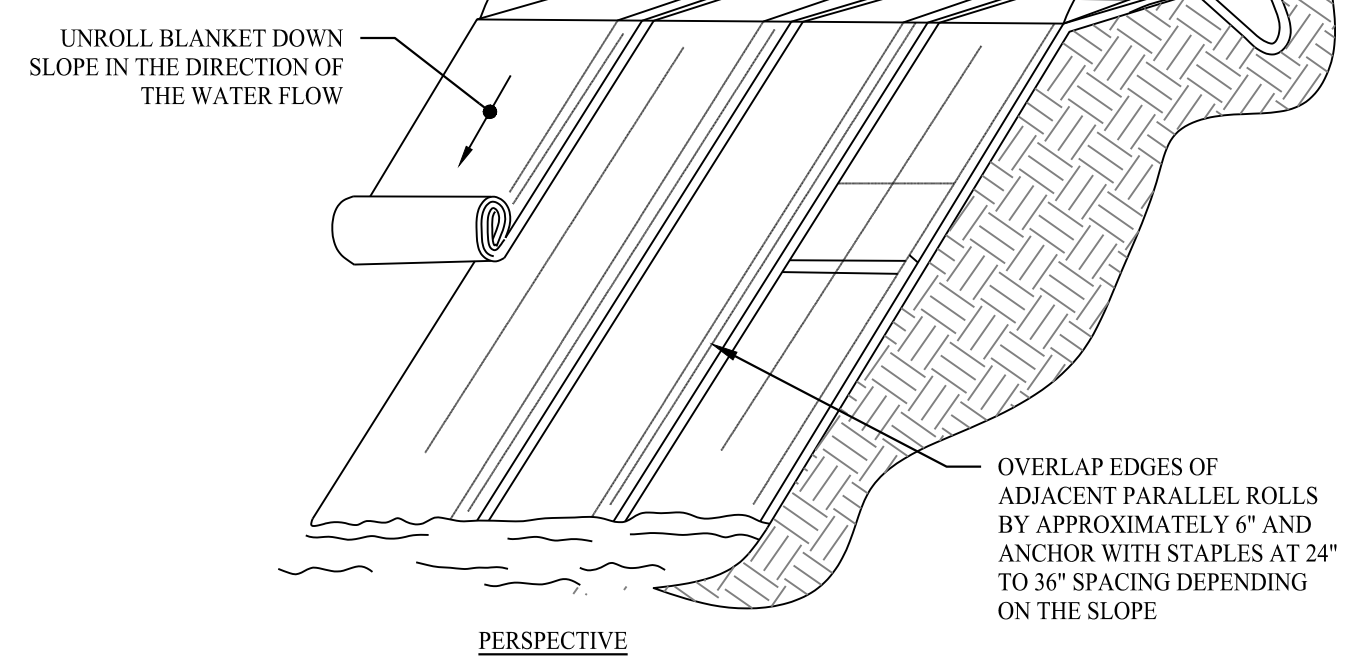

EROSION CONTROL BLANKET
(PROPOSED SLOPES 3:1 OR GREATER)
SCALE: NTS

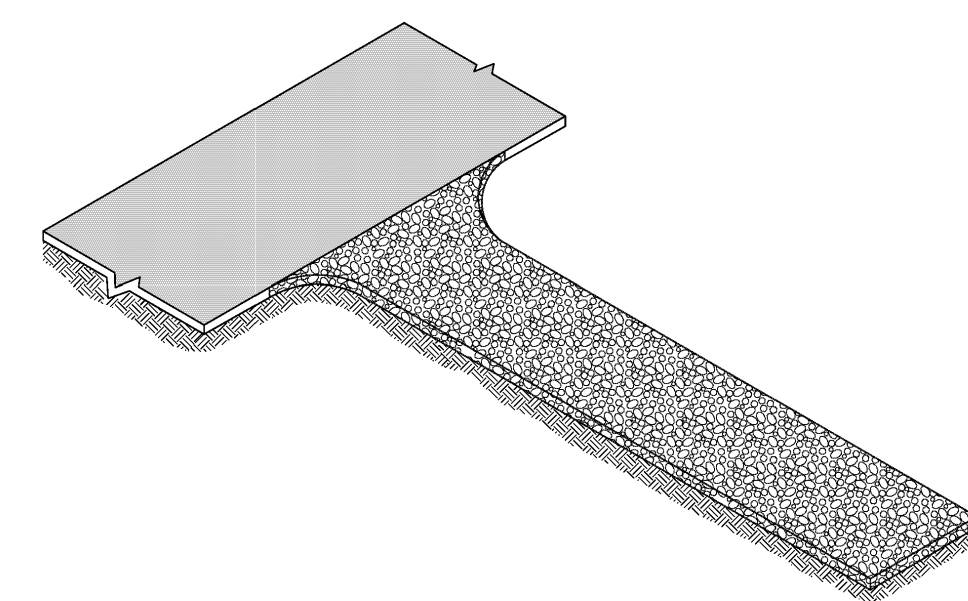

ANTI-TRACKING PAD

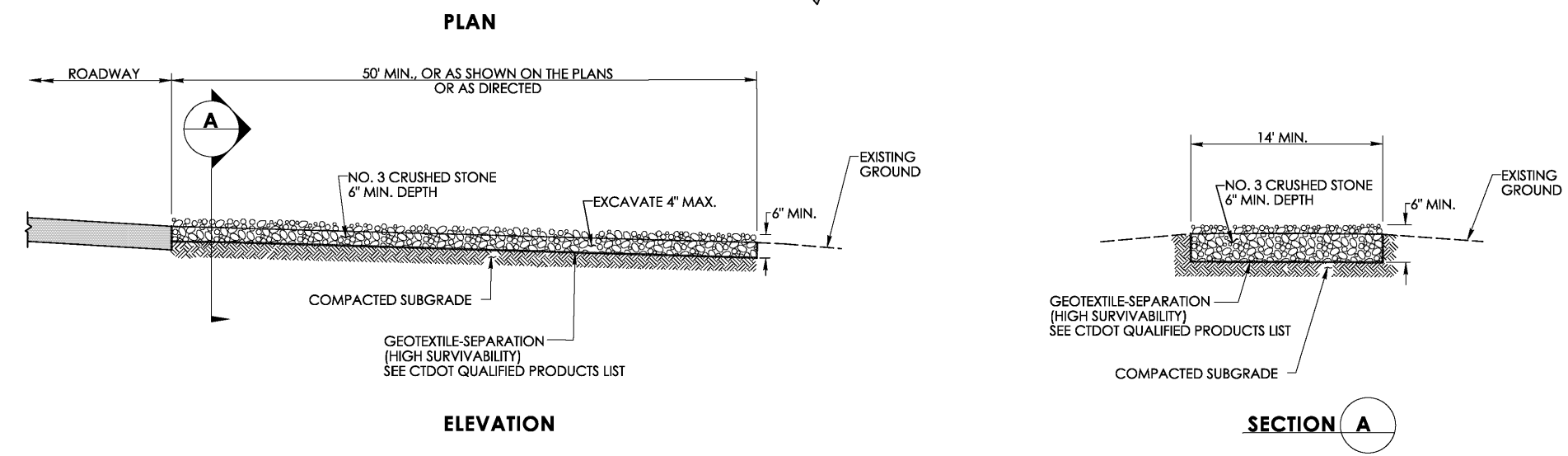

CONSTRUCTION ENTRANCE
SCALE: NTS
DETAIL PROVIDED BY THE CONNECTICUT DEPARTMENT OF TRANSPORTATION

CONSTRUCTION SEQUENCE

- INSTALL STABILIZED CONSTRUCTION ENTRANCE/EXIT.
- INSTALL SILT FENCE(S) ON THE SITE (CLEAR ONLY THOSE AREAS NECESSARY TO INSTALL SILT FENCE).
- HALT ALL ACTIVITIES AND CONTACT THE ENGINEER OF RECORD TO PERFORM INSPECTION AND CERTIFICATION OF BEST MANAGEMENT PRACTICES (BMPs).
- BEGIN CLEARING AND GRUBBING THE SITE.
- INSTALL ADDITIONAL EROSION CONTROLS AS WORK PROGRESSES, TOPSOIL AND SEED SLOPES WHICH HAVE ACHIEVED FINAL SITE GRADING.
- IMMEDIATELY UPON DISCOVERING UNFORESEEN CIRCUMSTANCES POSING THE POTENTIAL FOR ACCELERATED EROSION AND/OR SEDIMENT POLLUTION, THE OPERATOR SHALL IMPLEMENT APPROPRIATE BEST MANAGEMENT PRACTICES TO ELIMINATE THE POTENTIAL FOR ACCELERATED EROSION AND/OR SEDIMENT POLLUTION.
- THROUGHOUT CONSTRUCTION, REMOVE SEDIMENT FROM BEHIND SILT FENCES AND OTHER EROSION CONTROL DEVICES AS REQUIRED. REMOVAL SHALL BE ON A PERIODIC BASIS (EVERY SIGNIFICANT RAINFALL OF 0.10 INCH OR GREATER). INSPECTION OF EROSION CONTROL MEASURES SHALL BE ON A WEEKLY BASIS AND AFTER EACH RAINFALL OF 0.50 INCHES OR GREATER. SEDIMENT COLLECTED SHALL BE DEPOSITED AND SPREAD EVENLY UPLAND ON SLOPES DURING CONSTRUCTION.
- CONDUCT FINE GRADING.
- FERTILIZE SEED AND MULCH. SEED MIXTURE TO BE INSTALLED DURING THE SPRING OR FALL SEASON ONLY. USE EROSION CONTROL BLANKETS AS REQUIRED OR ORDERED FOR SLOPES GREATER THAN 3:1 AND AS SHOWN ON LANDSCAPE PLANS OR EROSION CONTROL PLANS. FOR TEMPORARY STABILIZATION BEYOND SEEDING DATES USE ANNUAL RYE AT 4.0 LBS/1,000 S.F. FERTILIZE WITH 10-10-10 AT 1.0 LBS. OF NITROGEN PER 1,000 S.F. AND LIME AT 100 LBS/1,000 S.F. (MAX.).
- UPON DIRECTION OF THE TOWN OF MONTVILLE AGENT (AFTER THEIR FINAL INSPECTIONS HAVE BEEN PERFORMED AND CERTIFICATES OF COMPLETION HAVE BEEN ISSUED), EROSION AND SEDIMENT CONTROL MEASURES SHALL BE REMOVED FOLLOWING STABILIZATION OF THE SITE.

LEGEND

	PROPERTY LINE
	ADJOINING LOT LINE
	BUILDING SETBACK
	EDGE OF PAVEMENT
	SAWCUT PAVEMENT LINE
	LIMIT OF WETLANDS
	LIMIT OF UPLAND REVIEW AREA
	EXISTING TREE LINE
	PROPOSED TREE LINE
	MAJOR CONTOURS
	MINOR CONTOURS
	EXISTING MAJOR CONTOURS
	EXISTING MINOR CONTOURS
	SILT FENCE
	75' WELL BUFFER
	EXISTING WELL

Rev. #:

Date

Description

Graphic Scale:

30

0

30

60

SOLLI
ENGINEERING

501 Main Street, Monroeville, CT 06468 T: (203) 880-5455 F: (203) 880-9695
11 Vanderbilt Ave, Norwood, MA 02062 T: (781) 352-8491 F: (203) 880-9695

Drawn By:

ARW

Checked By:

CJB

Approved By:

KMS

Project #:

22109401

Plan Date:

09/30/24

Scale:

1" = 40'

Project:

**PROPOSED 1-LOT
RESUBDIVISION OF
958 ROUTE 163**
(PARCEL ID : 046-008-000)
OAKDALE, CONNECTICUT
SEPTEMBER 30, 2024

Sheet Title:

**SOIL EROSION &
SEDIMENT
CONTROL PLAN**

Sheet #:

2.31

