

ADDENDUM NO. 1

Notice to Bidders for

Town of Montville
Public Works Drainage Improvements
2020-5

for
Town of Montville

ADDENDUM ISSUED: April 27, 2020

This Addendum forms part of the Contract Documents and modifies the original Project Manual & Specifications and Drawings dated April, 2020. Acknowledge receipt of this Addendum in the Bid Proposal. Failure to do so may subject the Bidder to disqualification.

This Addendum is issued to modify the Contract Documents as follows:

Bid Form Changes

1. Bid Form: DELETE Page 3 of the Bid Form in its entirety and replace with the attached Page 3. (Revised description of Bid Item 11)

Technical Specification Changes

1. Delete Page 25 of 29 to Technical Specifications:
 - a. DELETE Section 7.01 Slope Paving.

Plan Changes

1. Sheet 1 – Layout Plan: DELETE Layout Plan in its entirety and replace with Layout Plan ADD-1.
 - a. Removed references to stone sloped paving.

Response to Questions

1. Hello, I'm bidding the public works drainage improvement job and have a question on the stone slope protection is this 2' by 2' stone blocks as in the technical specifications But in bid items it's called crushed stone for slope protection there is a big price difference just looking for a little clarification.

Response: There is no requirement to install stone sloped paving. The intent of the project is to install ¾" crushed stone to the side slopes of the basin for the purposes of slope protection.

END OF ADDENDUM

10. Crushed Stone for Slope Protection 170 S.Y. _____

UNIT PRICE IN WORDS: _____

11. Grass Surface 300 S.Y. _____

UNIT PRICE IN WORDS: _____

12. Chain Link Fence 110 L.F. _____

UNIT PRICE IN WORDS: _____

TOTAL BASE BID PRICE: _____

TOTAL BASE BID PRICE IN WORDS: _____

The low bid will be determined by either of the following:

This contract is to be awarded to that responsible Bidder whose total bid is the lowest number of dollars for the above items.

If the Contractor should choose to employ manufacturers or suppliers other than those listed on the drawings and specifications, he shall submit a list of said suppliers as part of this proposal. If no list is included in the proposal, it shall be concluded by the Town that the Contractor will use only those suppliers listed on the drawings. An "or equal" supplier shall be included on the submitted list.

Wherever in the plans and specifications, an item of equipment or material is designated by reference to a particular brand, manufacturer or trade name, it is understood that an equal product may be substituted by the bidder or Contractor, under the conditions as stated above.

ADD-1

NOTES:

1. A PREBLAST SURVEY WILL BE PERFORMED SHOULD ANY BLASTING BE REQUIRED.
2. EXISTING UTILITY LOCATIONS ARE BASED ON THE BEST AVAILABLE INFORMATION. LOCATIONS MAY VARY BASED ON THE BEST AVAILABLE INFORMATION. LOCATIONS MAY VARY BASED ON AN ACCURATE FIELD DEMARCATION. ALL EXISTING UTILITIES TO BE ACCURATELY LOCATED PRIOR TO CONSTRUCTION. "CALL BEFORE YOU DIG" 1-800-922-4455.
3. NO ADDITIONAL SIGNAGE IS PROPOSED.
4. INSPECTION OF IMPROVEMENTS: THE ZONING OFFICER (OR DESIGNATED AGENT) SHALL CONDUCT PERIODIC INSPECTIONS OF THE IMPROVEMENTS PROPOSED AS PART OF A ZONING PERMIT IN ORDER TO INSURE COMPLIANCE WITH THE PERMIT AND THESE REGULATIONS.
 - A. AFTER THE INSTALLATION OF EROSION AND SEDIMENTATION CONTROLS.
 - B. AFTER THE INSTALLATION OF FOOTINGS.
 - C. AFTER STAKE OUT FOR DRIVEWAY AND SIDEWALKS.
 - D. AFTER THE COMPLETION OF THE DEVELOPMENT.
5. A PRECONSTRUCTION MEETING WITH THE PUBLIC WORKS DEPARTMENT MUST BE HELD PRIOR TO BEGINNING ANY CONSTRUCTION IN THE CITY RIGHT OF WAY.

CRUSHED STONE SLOPE (12" DEEP)
SLOPE=1:1.5 (TYP.)

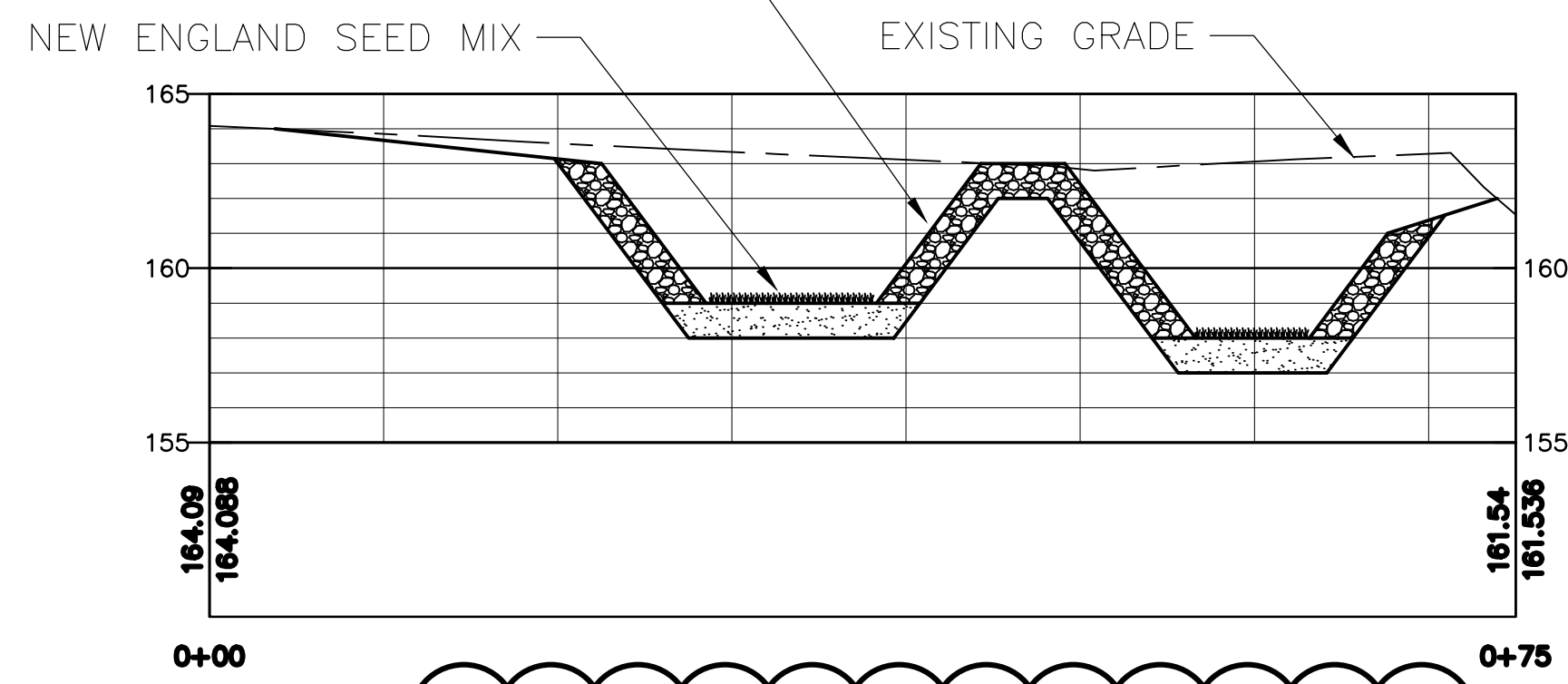

CRUSHED STONE SLOPED DETENTION POND

HORIZONTAL SCALE: 1"=10'
VERTICAL SCALE: 1"=2'

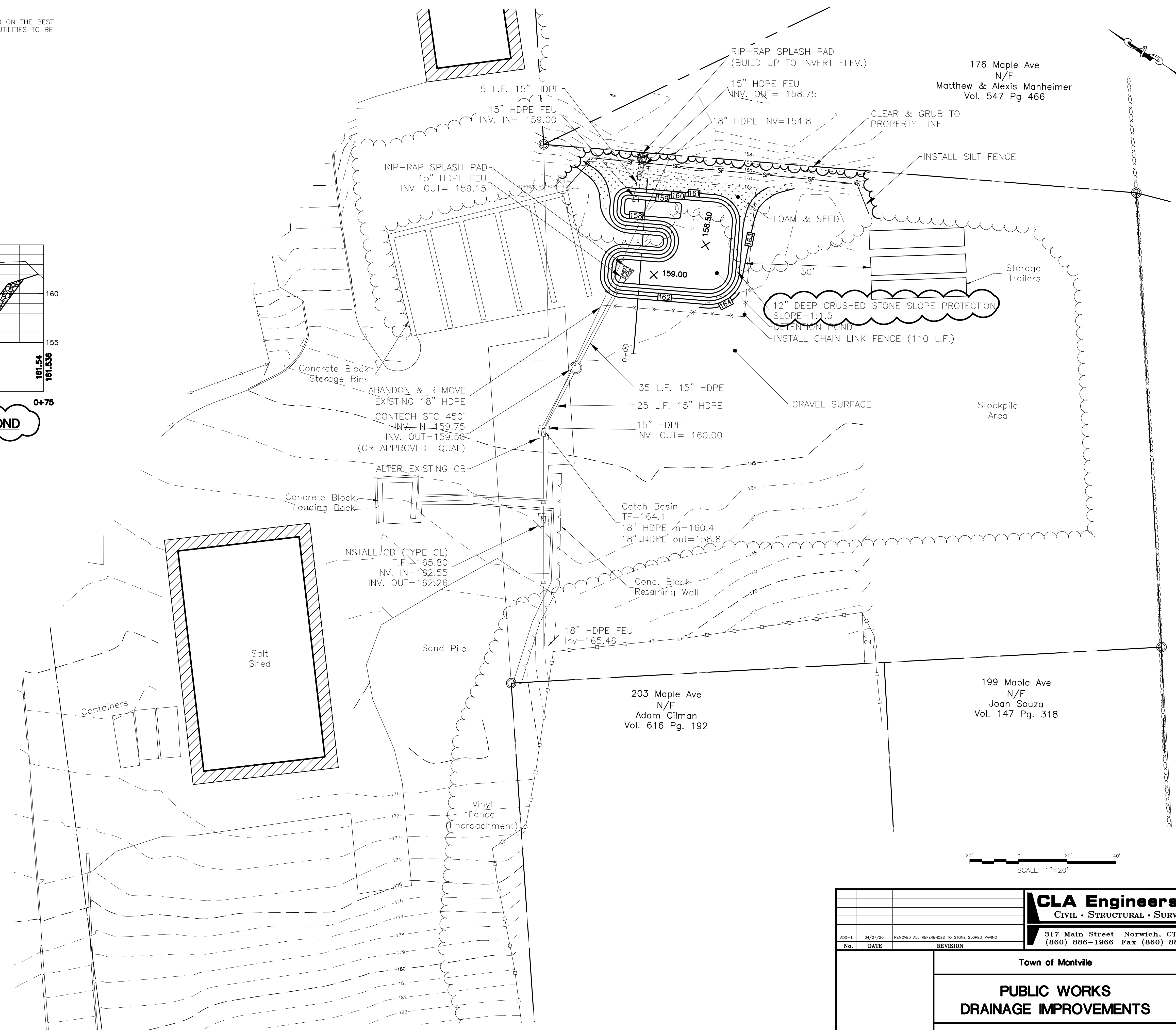

SCALE: 1"=20'

CLA Engineers, Inc. CIVIL • STRUCTURAL • SURVEYING 317 Main Street Norwich, CT 06360 (860) 886-1986 Fax (860) 886-9165		Project No. CLA-6471
		Proj. Engineer T.L.C.
Town of Montville PUBLIC WORKS DRAINAGE IMPROVEMENTS		Date: 04/10/20
LAYOUT PLAN		Sheet No. 1